

Art. No. 98810\_03/EN/06.2025

---

Aluminium systems

# Schüco folding-sliding systems

## AS FD 75 / AS FD 90.HI

---

en

Operating instructions for consumers



## Contents

<b>4</b>	<b>1. Notes on this document</b>
4	1.1. Use and retention of the instructions
<b>5</b>	<b>2. Opening types for folding sliding units</b>
5	2.1. Unit types that open inwards or outwards to one side
6	2.2. Unit types that open inwards or outwards to two sides
<b>7</b>	<b>3. Safety</b>
7	3.1. About the safety instructions
7	3.2. General safety instructions
8	3.3. Safety instructions for folding sliding units
11	3.4. Proper use
<b>12</b>	<b>4. Operation</b>
12	4.1. Folding sliding unit without side-hung vent
12	4.1.1. Opening
13	4.1.2. Closing
14	4.2. Folding sliding unit with side-hung vent
14	4.2.1. Opening
15	4.2.2. Closing
<b>16</b>	<b>5. Maintenance</b>
16	5.1. Cleaning and maintenance products
17	5.1.1. General cleaning instructions
17	5.2. Cleaning the vent and frame
17	5.2.1. Cleaning the tracks and drainage slots
18	5.2.2. Checking the gaskets
19	5.3. Maintenance
19	5.3.1. Locks
19	5.3.2. Maintenance of locking cylinders
19	5.3.3. Check and service the turn hinges
21	5.5. Correct ventilation
21	5.5.1. How to prevent damage caused by damp
22	5.5.2. Impact ventilation
<b>23</b>	<b>6. Decommissioning and disposal</b>
23	6.1. Decommissioning
23	6.2. Disposal

# 1. Notes on this document

## 1.1. Use and retention of the instructions

Before installing and commissioning, read through this manual thoroughly and adhere to the specified sequence of the instructions.

Schüco International KG shall not be liable for any damage which arises from a failure to adhere to these instructions.

These instructions are part of the product.

Keep them in an accessible place so that the information is always available.

## 2. Opening types for folding sliding units

### 2.1. Unit types that open inwards or outwards to one side

The types shown may have fewer or more vent pairs.

Type 3 LH

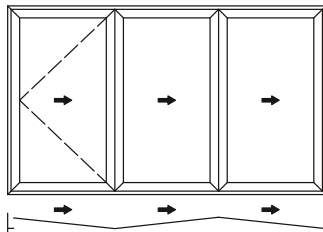

Type 5 LH

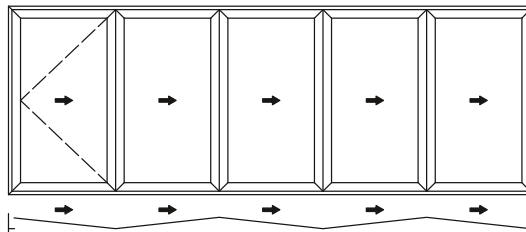

Type 7 LH

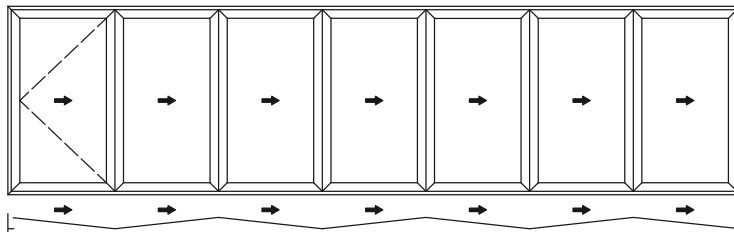

Type 2 LH\*

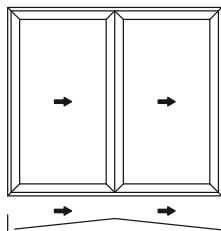

Type 4 LH\*

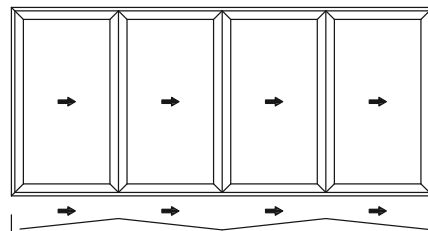

Type 6 LH\*

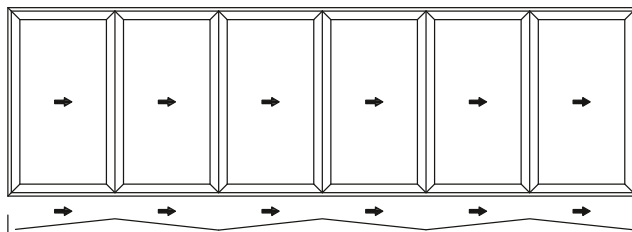

## 2.2. Unit types that open inwards or outwards to two sides

The types shown may have fewer or more vent pairs.

Type 1 LH / 3 RH\*

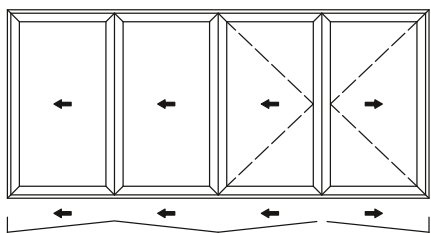

Type 3 LH / 3 RH\*

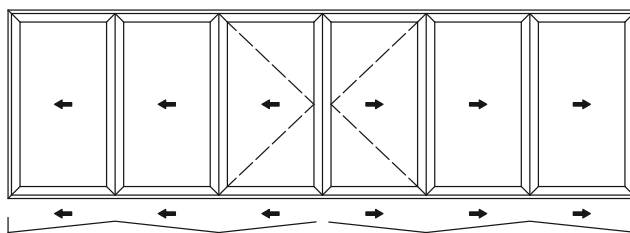

Type 5 LH / 3 RH\*

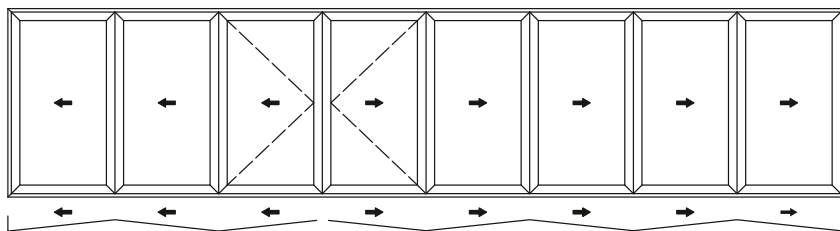

Type 2 LH / 2 RH\*

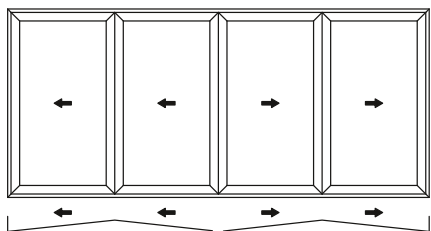

Type 2 LH / 4 RH\*

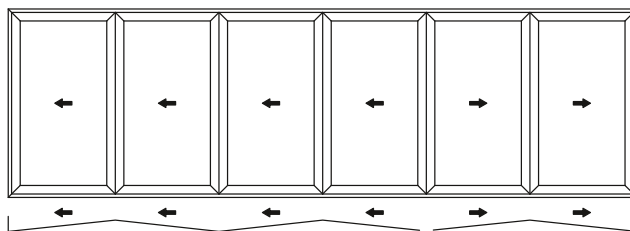

Type 2 LH / 1 RH\*

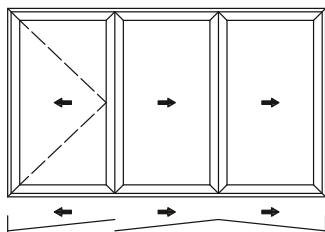

Type 2 LH / 3 RH\*

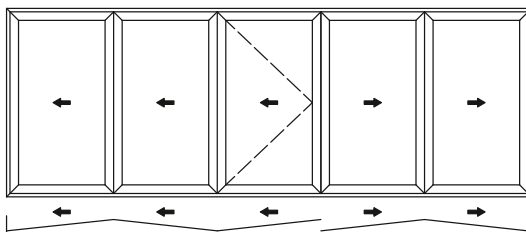

Type 4 LH / 3 RH\*

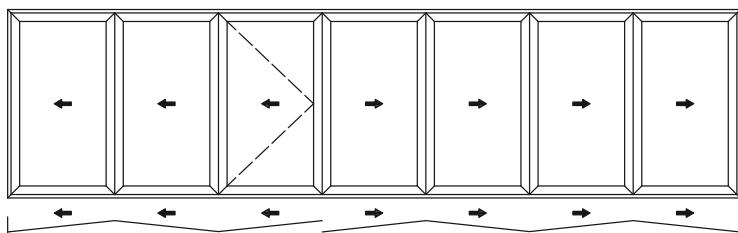

Typ 90°

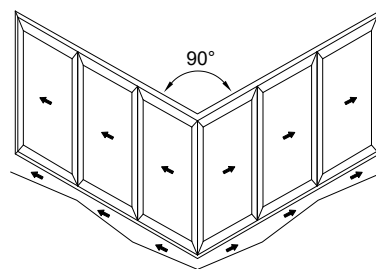

\* Available from Q4 / 2022



## 3. Safety

### 3.1. About the safety instructions



Type / source / consequence of the danger

Pictograms and key words advise of the type of danger and the level of danger:

<b>DANGER</b>		Imminent danger resulting in death or severe injuries.
<b>WARNING</b>		Potential imminent danger which may lead to death or severe injuries.
<b>CAUTION</b>		Potentially dangerous situation which may lead to minor injuries.

### 3.2. General safety instructions

Follow the safety instructions in this document so as not to endanger your own life or that of others and to ensure error-free operation.

For reasons of simplicity, this manual does not contain every detail of all product types and it cannot cover every possible installation, operation or maintenance scenario.



#### **Danger of falling**

There is a risk of falling out of open units.

Do not leave open units unsupervised.

### 3.3. Safety instructions for folding sliding units



When using folding/sliding units units, take note of the hazards listed below.

#### Danger to hands / fingers

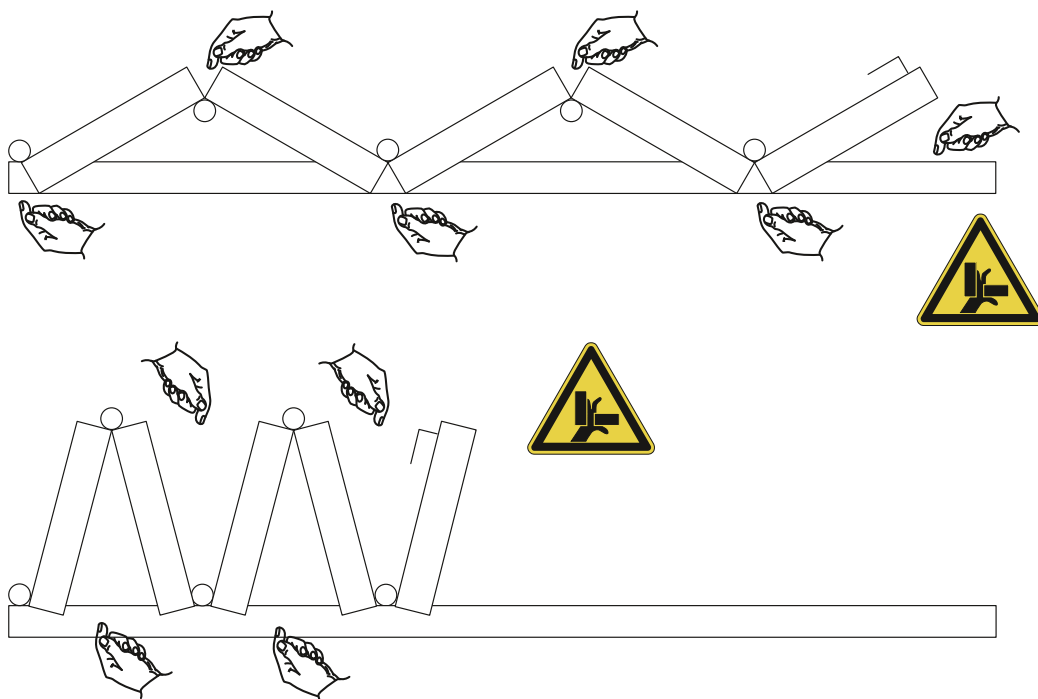

#### Danger for the body / head area

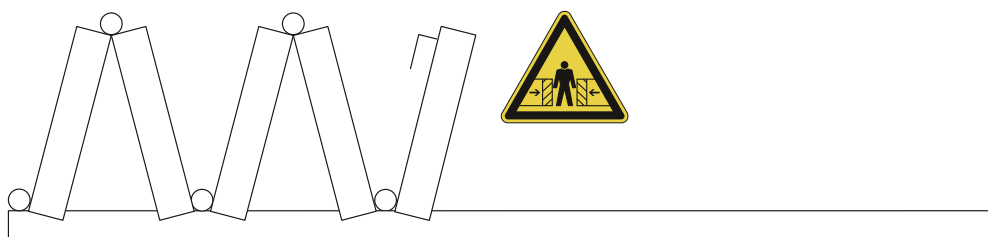

**CAUTION**

Note the following advice to prevent damage to the units.

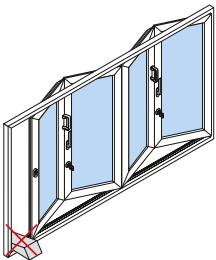
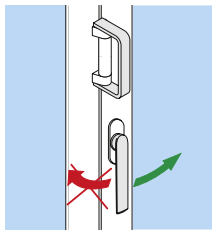
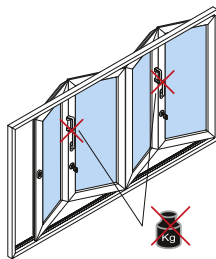

- ▶ Do not load extra weight onto the frame or handles. The additional load may cause deformation of the unit frame or damage to the unit handles and side-hung fittings.
- ▶ Operate the unit handles in the correct direction only and do not force them beyond the anti-turn stop. The additional load may cause damage to the unit handles and lock fittings.
- ▶ Do not wedge anything between the unit leaf and frame. The additional load may cause deformation of the unit frame or damage to the unit handles and side-hung fittings.
- ▶ Sun cream residue, which may be left on the surface of the unit and vent frames when touched by hands coated in cream, must be removed immediately. Otherwise, this may lead to permanent damage to the surface finish. (For information on cleaning, see the Maintenance section.)

 **CAUTION**

Note the following advice to prevent damage to the sliding units.

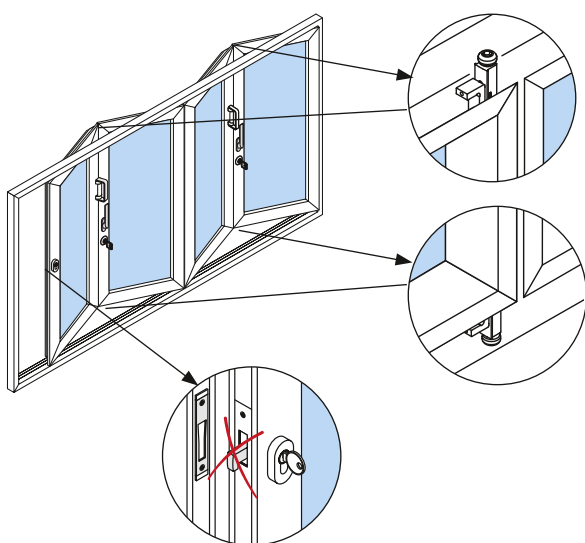

- ▶ The unit vent must NOT be locked when the vent is open. Closing the unit vent when the lock is engaged can damage the unit frame.

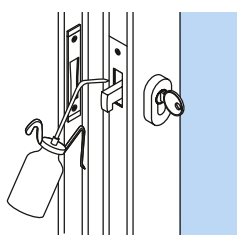

- ▶ Any stiffness of the locks must be remedied immediately (oil / grease, replace if necessary).

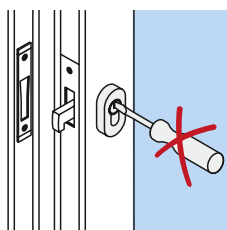
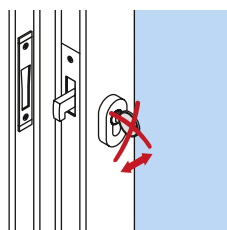

- ▶ Do not pull/push the doors using inserted keys.
- ▶ Do not insert any foreign objects into the keyhole.

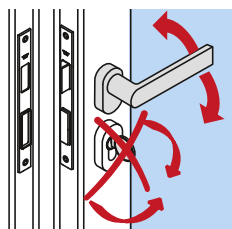

- ▶ Do not operate the handles and the keys simultaneously.

### 3.4. Proper use

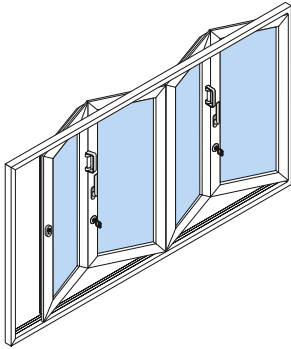

A folding/sliding unit consists of a unit frame installed in a fixed position in the building and multiple horizontal folding unit vents which are guided on rollers in tracks along the top or bottom.

Folding units enable large access widths. Folding units are therefore particularly suitable for verandas and access to conservatories, or as a room divider for conference rooms and halls in the hotel, hospitality and events industry.

The advantage of folding units over sliding units is that the sliding unit requires an amount of space at the side equal to at least one full vent width, while the folding unit can be reduced to a dimension of vent thickness x number of vents.



#### **WARNING**

Incorrect use or unauthorised modification of the product may result in death or serious injury, or damage to the product and other material assets. Only original replacement parts may be used. The manufacturer / supplier shall not be liable for any damage resulting from infringement. The user alone bears the risk.

As the folding system contains profiles with thermal break, there may be a drop in temperature inside the profiles.

At the same time, the good insulating properties of the thermal break mean that the temperature of the room side of the profiles will only differ slightly from the room temperature, while the outside may heat up or cool down significantly due to the outdoor temperatures and the solar radiation.

At the same time, the room side and outside of the profiles expand differently depending on their respective temperatures.

This may lead to unwanted deformations, which cause temporary stiffness.

This is particularly the case if, for folding systems with a side-hung vent, the side-hung vent is kept open for a long period of time and therefore the room side of this vent is exposed to solar radiation, while the rest of the folding vent is closed, the outside of which is exposed to solar radiation.

As soon as the solar radiation ends, the curvature regresses and the usual smooth operation returns.

This is a normal physical process and is not a fault.

To minimise these temperature-related deformations through solar radiation, it is recommended that you provide shading for the folding system (e.g. canopy) or use a light profile colour if your system faces a southerly or westerly direction.

## 4. Operation

### 4.1. Folding sliding unit without side-hung vent

#### 4.1.1. Opening

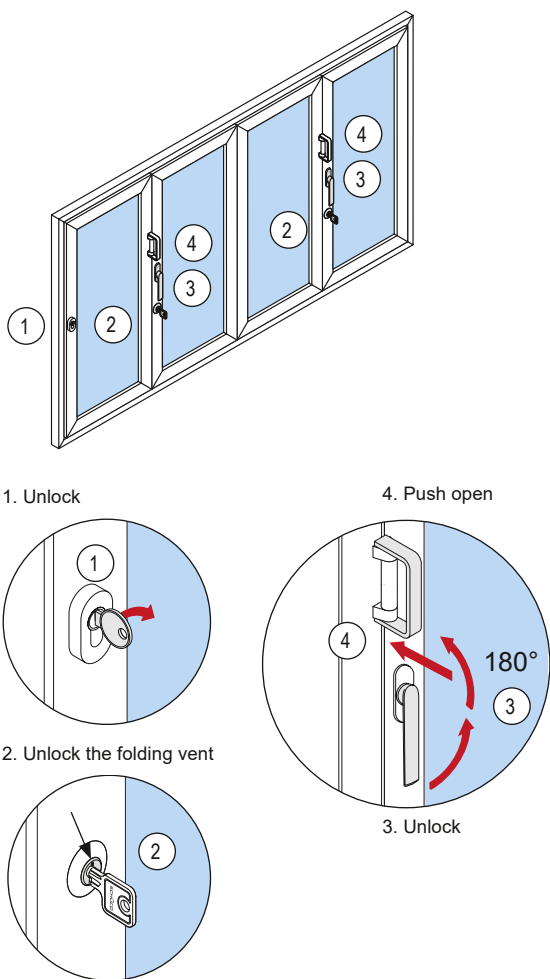

#### **WARNING**

During opening and closing, do not place hands in the area where the units fold, as there is a danger that fingers may become trapped.

The operation described only applies to the unit type shown.

#### **Opening**

1. Unlock the lock (1) by turning the key, then remove the key
2. Unlock the folding vent by turning the turn lock (2), then remove the key  
Turn lock marking = 0 at top  
Open – the door/fold can be opened
3. Unlock the folding vent by turning the handle (3) 180°
4. Open the folding vent by pushing the vent profile (4)
5. Push open the folding sliding unit

## 4.1.2. Closing

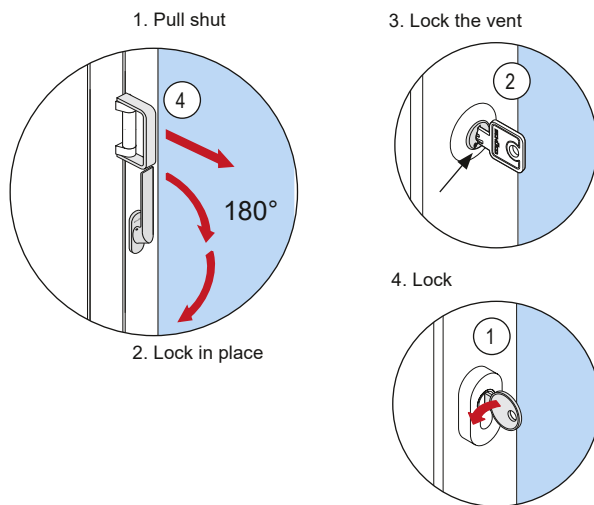
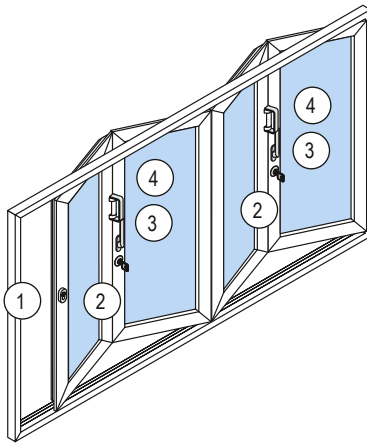

### **WARNING**

During opening and closing, do not place hands in the area where the units fold, as there is a danger that fingers may become trapped.

The operation described only applies to the unit type shown.

### **Closing**

1. Pull the vent into the unit frame using the handles (4)
2. Lock the folding vents in place by turning the handles (3) 180° downwards
3. Lock the folding vent by turning the turn lock (2)  
Turn lock marking = 0 at bottom  
Locked – the door/fold is locked
4. Lock (1) by turning the key

## 4.2. Folding sliding unit with side-hung vent

### 4.2.1. Opening

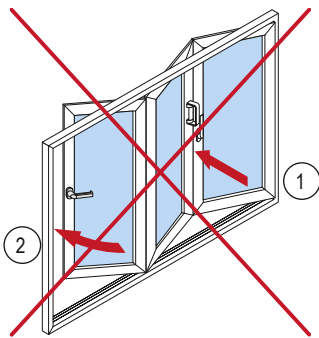

Follow the opening sequence!

If the folding vent (1) is unlocked before the side-hung vent (2) has been secured, the side-hung vent may swing open in an uncontrolled manner and there is a risk of injury.

This may lead to deformation of the unit frame and damage to the side-hung and lock fittings.

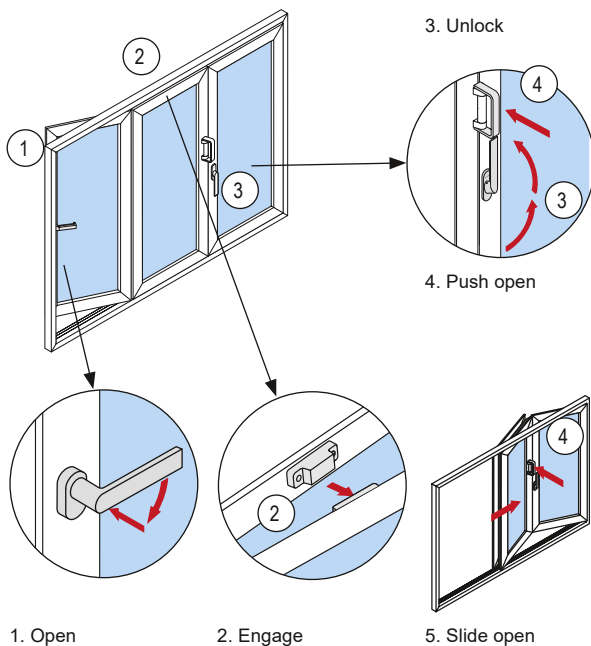

1. Open

2. Engage

5. Slide open



During opening and closing, do not place hands in the area where the units fold, as there is a danger that fingers may become trapped.

The operation described only applies to the unit type shown.

1. Open side-hung vent (1) 180°
2. Engage in the magnetic retaining catch (2) of the adjacent vent and fix in place
3. Unlock the folding vent by turning the handle (3) 180°
4. Open the folding vent outwards by pushing the handle (4) or open inwards by pulling the handle
5. Slide open the folding vent

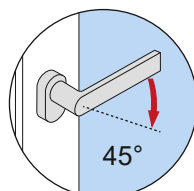
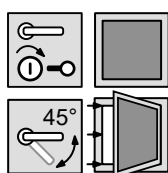

6. Unlock

6. To unlock handle-operated multi-point locking, turn the door handle 45° (or as far as it will go) downwards

### 4.2.2. Closing

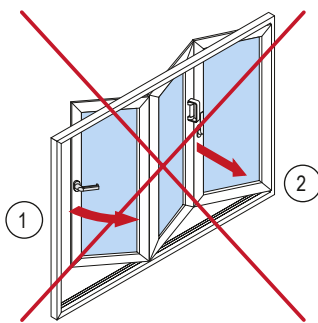

Follow the closing sequence!  
 If the side-hung vent (1) is disengaged before the folding vent (2) has been locked, the side-hung vent may swing open in an uncontrolled manner and there is a risk of injury.  
 This may lead to deformation of the unit frame and damage to the side-hung and lock fittings.

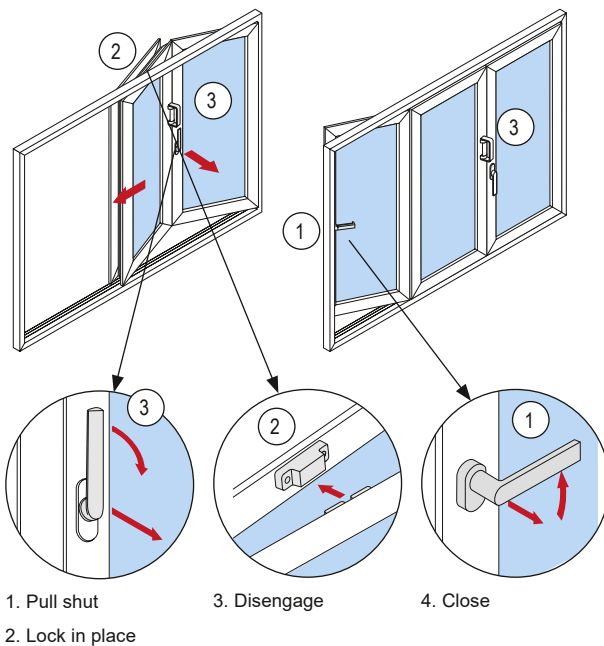

During opening and closing, do not place hands in the area where the units fold, as there is a danger that fingers may become trapped.

The operation described only applies to the unit type shown.

1. Pull the folding vents shut using the handles (3)
2. Lock the folding vents in place by turning the handles (3) 180° downwards
3. Release the side-hung vent from the magnetic retaining catch (2)
4. Close and lock the side-hung vent (1)

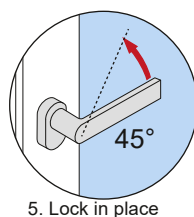
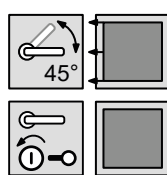

5. To lock handle-operated multi-point locking, turn the door handle 45° (or as far as it will go) upwards

## 5. Maintenance

First perform the following visual checks:

- » Check all vents and accessible gaskets for irregularities and glass breakages
- » Check that all switches are intact / not damaged

### 5.1. Cleaning and maintenance products



When cleaning colour-coated units, observe the instructions for use of the cleaning agent.

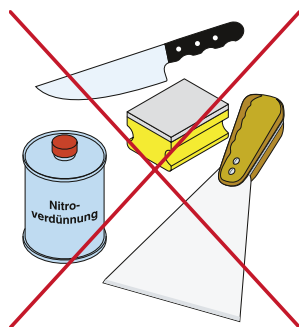

**The following items must NOT be used for cleaning:**

- ▶ Tools with sharp edges, e.g. knives, metal scrapers, steel wool, the scouring side of household sponges etc. will damage surfaces.
- ▶ Aggressive cleaning fluids or solvents, e.g. cellulose thinner, nail polish remover etc. will also cause irreversible damage to unit surfaces.

Cleaning agents suitable for aluminium units are available from Schüco specialists.

#### **Aluminium maintenance kit 298 672:**

- Cleaner and preservative
- Stainless steel cleaner
- Grease stick to maintain gaskets
- Lubricating spray to maintain fittings



#### **Maintenance products for anodised aluminium units:**

##### **Basic cleaner 298 181**

For initial and basic cleaning.  
Cleans and preserves the aluminium surface.

##### **Metal polish 298 010**

This cleaner for anodised surfaces restores the matt finish to the aluminium and preserves the surface (can also be used on stainless steel).

##### **Universal aluminium cleaner 298 001**

Removes stubborn grime, minor scuff marks and scratches.



### 5.1.1. General cleaning instructions



For the best window care, clean the window frames and gaskets at the same time as the window panes. Use a mild, non-scouring cleaning agent.

#### **Solid substances**

Plaster, mortar or similar is best removed using a wooden or plastic spatula.

#### **Marks**

Can be removed safely and without residue using a cleaning agent from our range of cleaning products for aluminium units.



#### **CAUTION**

To prevent damage, observe the instructions for use given on the cleaning agent.

## 5.2. Cleaning the vent and frame

### 5.2.1. Cleaning the tracks and drainage slots

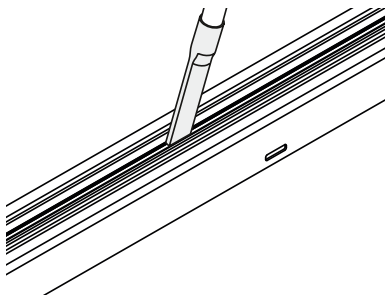

- ▶ Move all the vents in the system into the "open" position.
- ▶ Check the rollers and drainage slots in the entrance area for dirt
- ▶ Remove any dirt using a vacuum cleaner or a suitable cleaning agent
- ▶ Blocked drainage slots can be cleaned using a cocktail stick or cotton bud

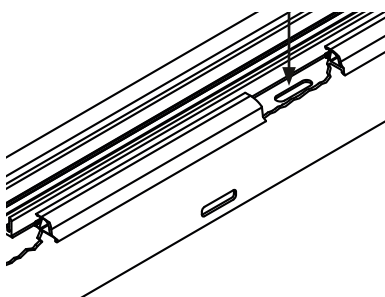

- ▶ Check the rollers for any damage and stiffness. Replace any damaged or stiff rollers.

### 5.2.2. Checking the gaskets

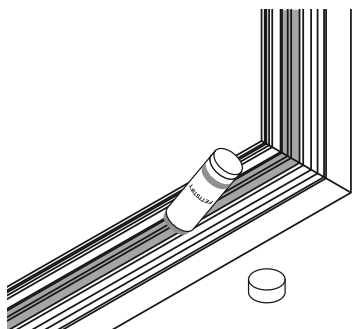

- ▶ Rub all gaskets with a grease stick or Vaseline. This will maintain suppleness and prevent sticking
- ▶ At the same time, check all gaskets for damage



#### **CAUTION**

Ask a Schüco specialist to replace any defective gaskets.

## 5.3. Maintenance

In addition to normal cleaning and maintenance, you should carry out a brief inspection of your aluminium units annually. This will extend the working life of the units and maintain ease of use.

### Maintenance work to be performed at least once a year (in school and hotel buildings every six months):

- Ensure fittings components are secure and check for any signs of wear. If required, tighten fixing screws and have a specialist company replace worn components.

#### 5.3.1. Locks

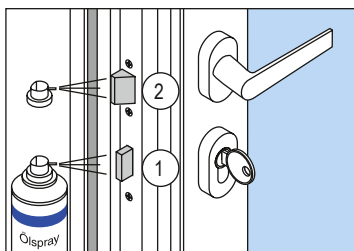

For locks, the bolt (1) and latch (2) must be lubricated as necessary.

#### Before lubrication:

- Lock the lock to expose the bolt

#### After lubrication:

- Unlock the lock to conceal the bolt

#### 5.3.2. Maintenance of locking cylinders

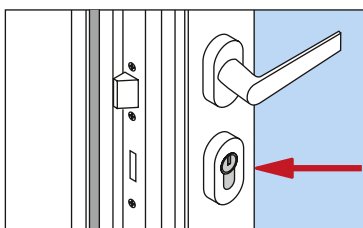

Depending on the loading, the locking cylinders must be maintained at least twice a year.

- Only use graphite powder to lubricate the lock cylinder

#### 5.3.3. Check and service the turn hinges

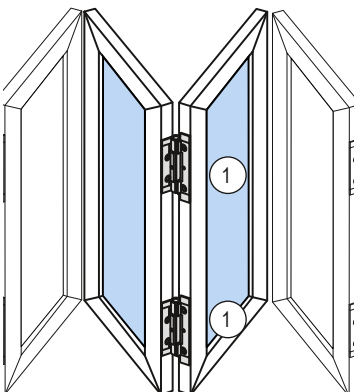

Check the turn hinges

- Check the turn hinges (3) are secure and check for damage
- If required, arrange for a Schüco specialist to tighten the fixing screws or have the parts replaced by a Schüco specialist.

Service the turn hinges

- The turn hinges must be oiled or greased regularly (yearly / every six months, see above)

## 5.4. Maintenance

### 5.4.1. Maintenance contract

If these operating instructions do not answer all your questions, refer to your Schüco specialist for help or contact Schüco directly. In addition to providing expert advice, they can advise you on particular modifications and repairs.

Schüco specialists and Schüco International KG can offer you the additional benefit of a maintenance contract. Under the terms of the maintenance agreement, they will undertake all maintenance and repair work. Your units will be maintained at their optimum functional performance and value without the need for additional resources.



#### CAUTION

The fittings in the window, door and façade units require specialist, systematic maintenance, care and inspection to ensure they retain their value and remain fit for use and safe. Therefore, it is recommended that you conclude a corresponding maintenance contract for windows, doors and façades.



#### DANGER

- ▶ Risk of injury due to maintenance work carried out incorrectly.
- ▶ Incorrect maintenance could lead to severe injury or damage to property.



#### CAUTION

All repairs and modifications should be undertaken by a Schüco specialist or by Schüco International KG directly. Only repairs by a specialist using “original parts” ensure the continued correct operation of your Schüco units.

To conclude a maintenance contract with Schüco International KG, please contact Schüco directly:

Tel. +49 521 783 1111

[serviceteam@schueco.com](mailto:serviceteam@schueco.com)

## 5.5. Correct ventilation

### 5.5.1. How to prevent damage caused by damp

The high weathertightness of the Schüco unit systems reduces the exchange of air between the inside and outside. Depending on use, high humidity loads could occur. This is caused by evaporation from people and plants and facilities with high humidity levels such as bathrooms and kitchens.

The accumulation of water vapour leads to an increase in humidity and has to be let out to prevent damage caused by damp. The formation of condensation on materials that are not sensitive to water such as aluminium window frames and glass is permissible for a short time and in small quantities (DIN 4108-2). This phenomenon can be countered by sufficient ventilation.

#### Ventilation in summer / winter

##### Summer

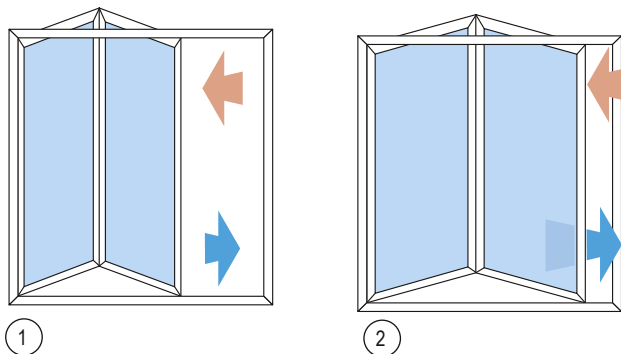

- ① Short impact ventilation
- ② Prolonged ventilation only when heating is switched off.

##### Winter

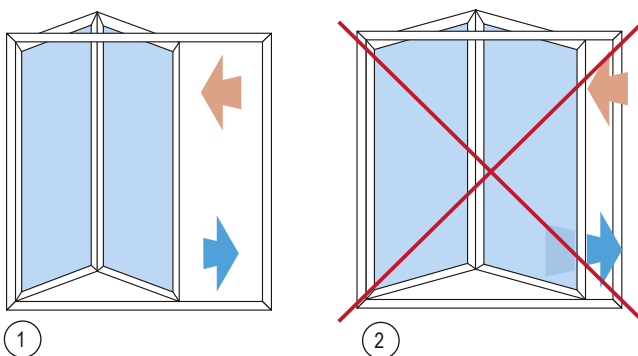

- ① Short impact ventilation
- ② Avoid permanent ventilation through open vents in winter to prevent the interior becoming too cold.





### 5.5.2. Impact ventilation

Depending on use, the unit should be completely opened several times a day to ensure impact ventilation. As illustrated the perfect ventilation time depends on the time of year and should be in the range of 4–6 minutes in winter.

Impact ventilation ensures maximum protection against moisture damage. This effective exchange of damp air requires little heat energy as the interior barely cools down at all during the short period of ventilation.

The ventilation is even more economical if the thermostat valve is turned off during ventilation and back on after the windows are shut again.

#### Recommended duration of impact ventilation (1) by month:

December, January, February	4 - 6 minutes	
March, November	8 - 10 minutes	
April, October	12 - 15 minutes	
May, September	16 - 20 minutes	
June, July, August	25 - 30 minutes	

Ventilation time required to exchange the air during impact ventilation (wide open window with no wind) depending on seasonal outside temperature.

## 6. Decommissioning and disposal

### 6.1. Decommissioning

A specialist should dismantle the units.

### 6.2. Disposal

Commission a specialist to dispose of the units professionally.

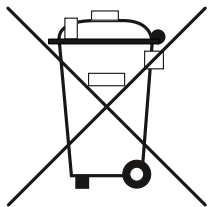

The materials used can be recycled.  
Observe the environmental requirements with regard to recycling, re-use and disposal of operating materials and components in accordance with the local, country-specific and international current technical regulations and official regulations.  
Make a contribution towards protecting our environment and dispose of the device at a collection point.

en Original instructions

Schüco International KG  
Karolinenstraße 1-15  
33609 Bielefeld  
Tel. +49 (0)521 783-0  
Fax +49 (0)521 783-451  
[www.schueco.com](http://www.schueco.com)

The "Schüco" logo and other logos are protected in Germany and various international markets. Detailed information is available upon request.

Art.Nr. 998810/EN/06.2025/Printed in Germany  
We reserve the right to make changes and to correct errors. Products may differ from illustrations.