

IMPACT ACOUSTIC®

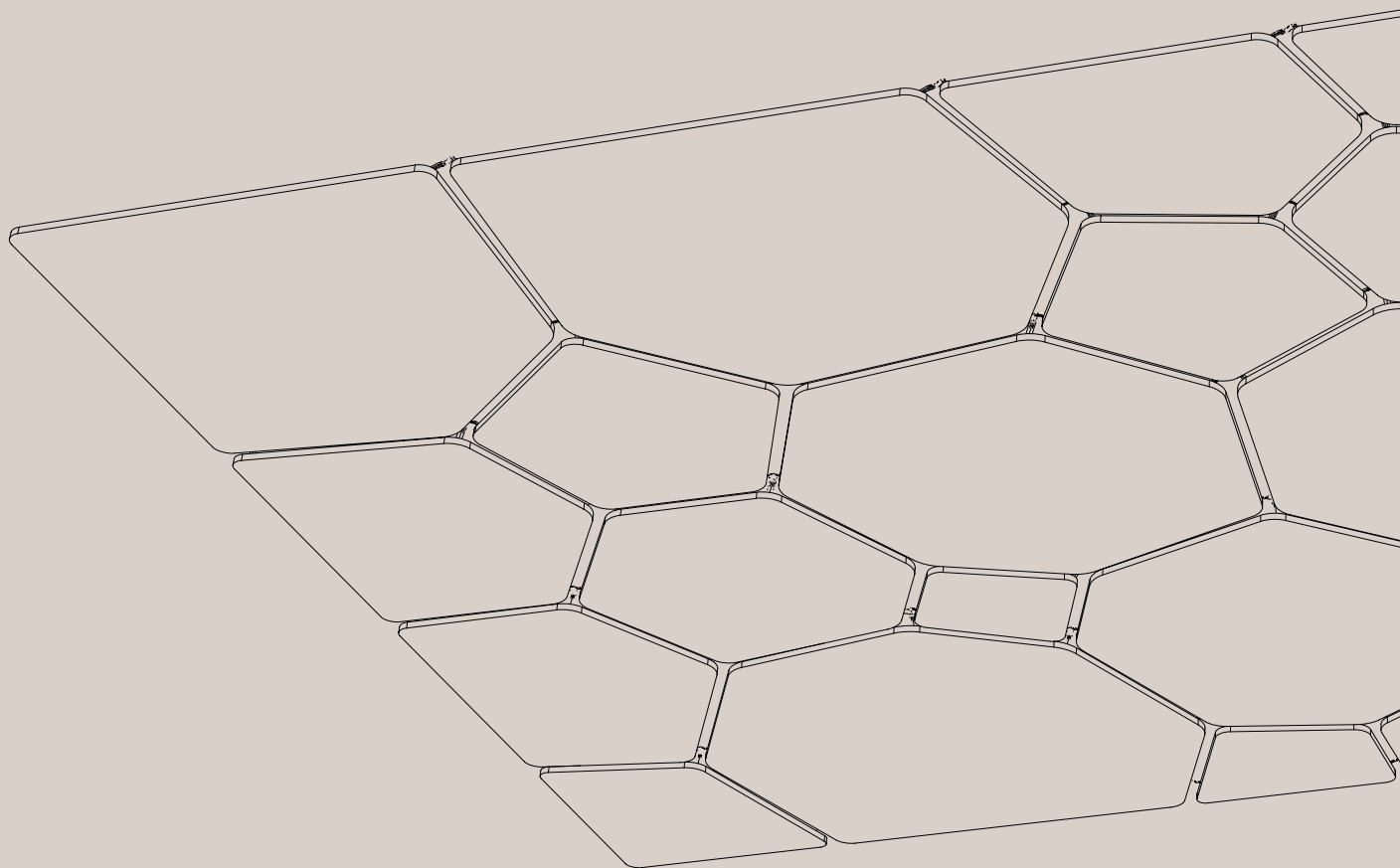

Plateau

Ceiling Systems

714.24.10.000.00

TECHNICAL DATA SHEET

Plateau Ceiling System

General Information



Data

Applicable article numbers

714.24.10.000.00

Dimensions¹

Length *on request*

Width *on request*

Material thickness 24mm 0.94"

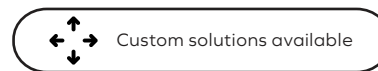

Material

Panels 100% PET (60% post-consumer) in 36 colours.

Mounting System Aluminium (powder coated black)



Weight²

Panels 4kg/m² (±10%)

0.82 lbs/ft² (±10%)

Included

Ceiling panels

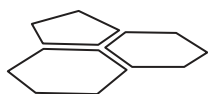

Suspension system



Spot lights
(on request)



Installation guide



Design revision

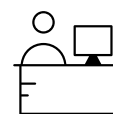

Warranty
10 years³



1 - all dimensions are nominal 2 - all weight values are nominal 3 - Impact Acoustic warranty terms apply

Plateau Ceiling System

Specification Guide

Ensure you make the perfect choice by choosing our solutions for your next project. To get started, simply define some basic information and constraints about your space. Then explore our range of standard solutions or contact us directly for a more in-depth discussion of personalised customized options.

1 Prepare this information:

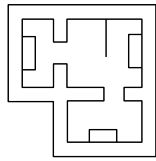

Project Area

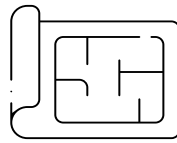

Ceiling Plans (RCP)

page 8

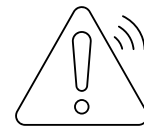

Other Considerations

page 8

2 Specify your options:

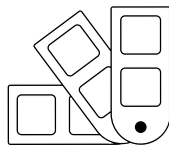

Colour

page 8

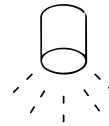

Lights

page 7

Plateau Ceiling System

Geometry Information

Custom solutions available

Reference geometry

Plateau system is a highly customizable bespoke ceiling acoustic solution. Our design team is able to create variety of solutions to fit any particular space requirements you might have, thus no two single applications of Plateau system will be the same - contact us for more details.

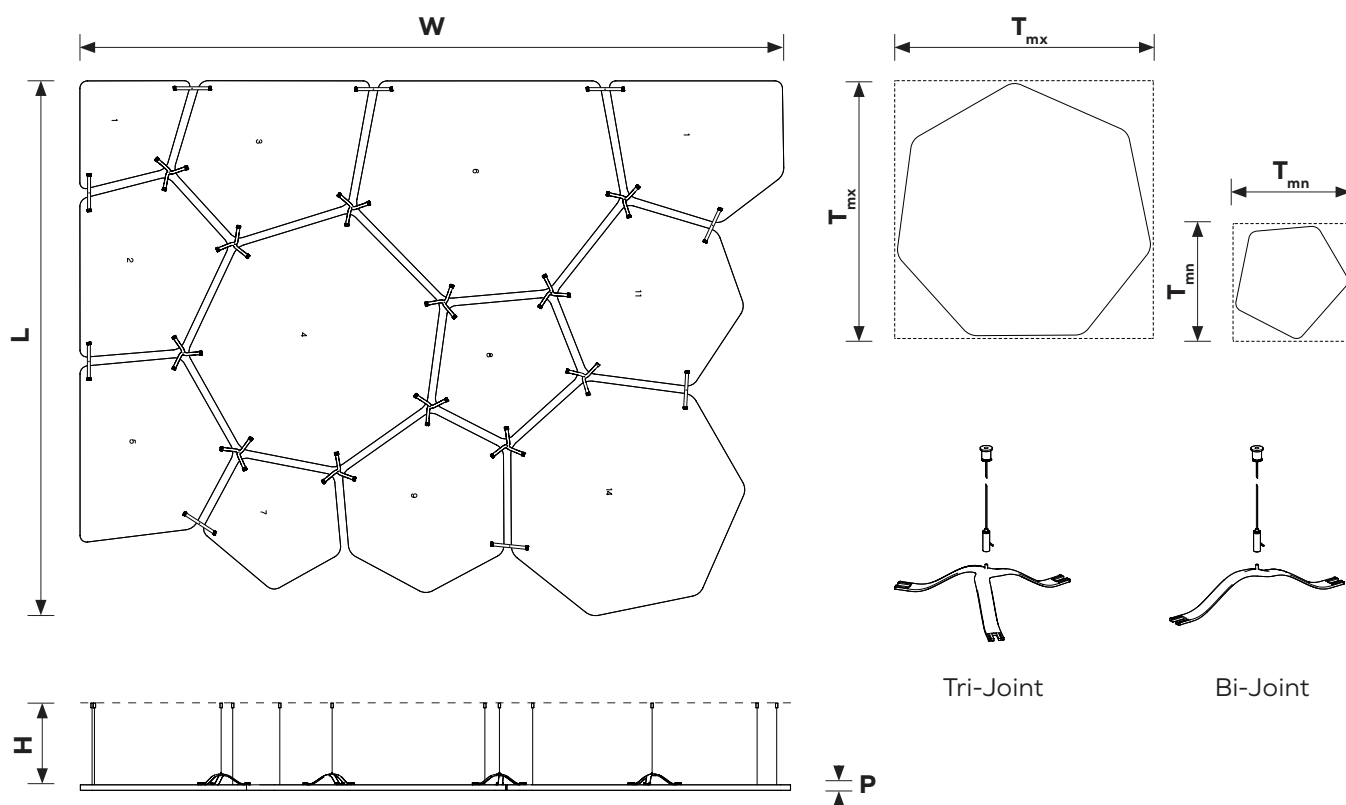

Dimensions table

W	Total width	on demand	on demand	<i>bespoke</i>
L	Total length	on demand	on demand	<i>bespoke</i>
T_{mx}	Panel max size	1800mm	70.87"	<i>maximum</i>
T_{mn}	Panel min size	800mm	31.50"	<i>recommended min.</i>
H	Distance from ceiling	150-1400mm	5.90"-55.12"	<i>adjustable range.</i>
P	PET material thickness	24mm	0.94"	

Plateau Ceiling System

Planning Considerations

When planning the addition of a Plateau Ceiling System to your space, please consider the following aspects.

1 Project area

Check and verify the project area where the Plateau System will be installed. This will allow us to provide you with an accurate quote.

If possible provide RCP drawings. This will help plan for any obstacles like columns and air-ducts that might collide with the Plateau.

2 Integrated light

Plan for proper light conditions in the space. You can easily implement our optional LED spot light (1) solution in selected panels. We recommend performing a light analysis for your space in order to specify the right quantity and location of spot light elements. See more on page 7.

3 Additional considerations

Consider access to high windows and doors.

Verify the type of material to which the support elements will be mounted. Plateau is using point-wire mounting system. See more on page 6.

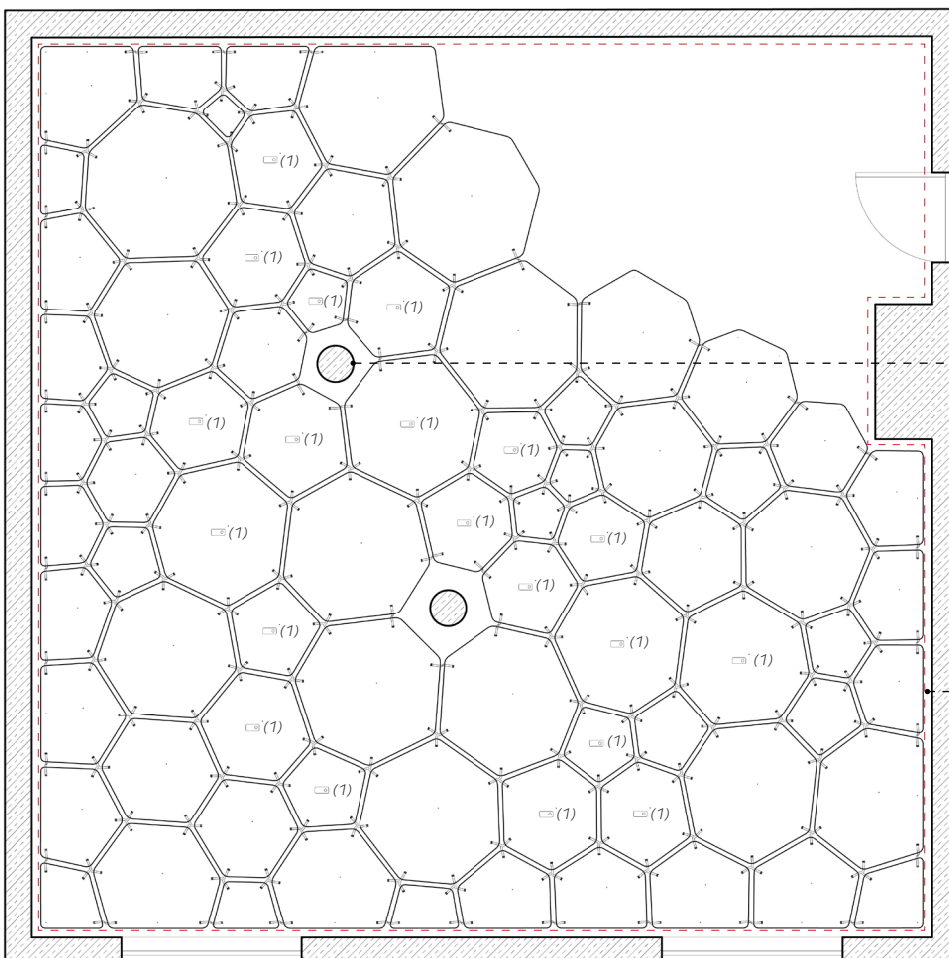

Consider position of columns and other vertical elements in the space. Plateau can be easily adjusted to accommodate for those.

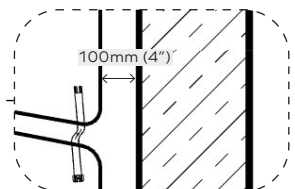
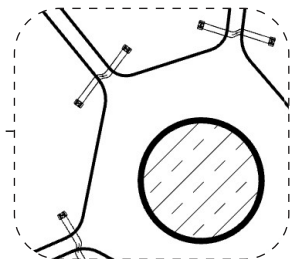

Plan for providing min. 100mm (4") safe space distance from panels to other elements

Plateau Ceiling System

Installation Overview



Extended document available

1 Verify and organize

Verify all delivered elements and organize them based on the included labeling and provided cardboard plans.

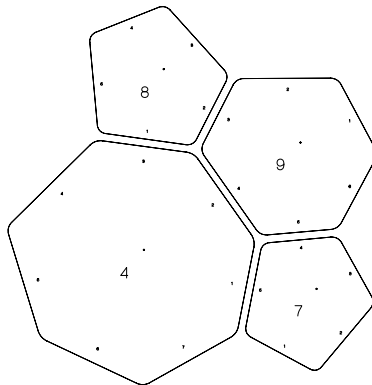

2 Fix hardware to ceiling

Use a vertical laser level to mark the locations of all suspension points on the ceiling. Fix hardware to ceiling on all marked suspension points as per the shop drawing.

3 Attach additional hardware to the panels

Fix hardware to the marked side of the panels. Align clips to rectangular markings and attach with screw (A). Screw in the double sided gripper screws in a position of circular markings (B).

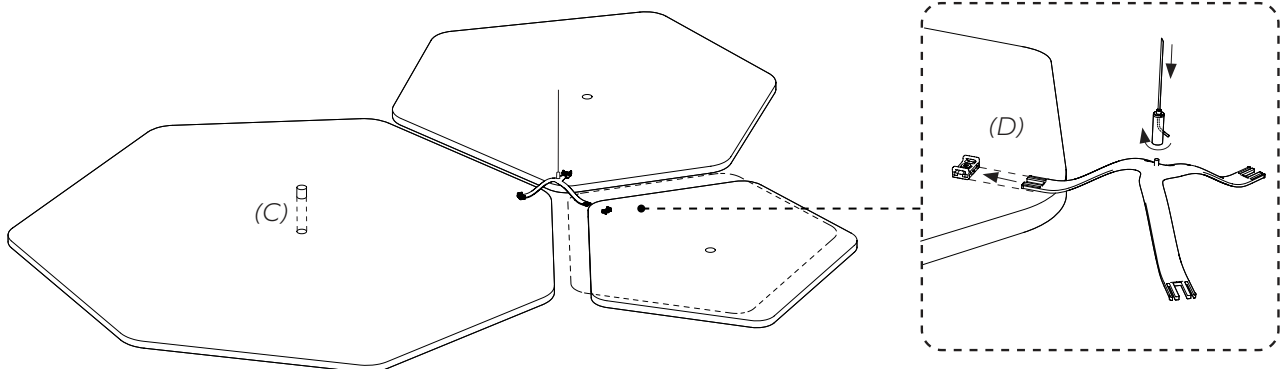
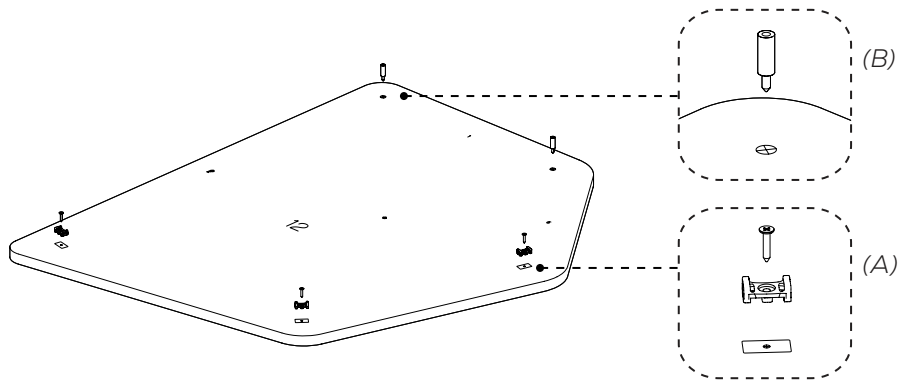

4 Install lights (optional)

Remove the central circular cut-out from the panels you wish to install the lights in (C). Push the spotlight into the opening and screw the driver to the panel.

5 Attach cables to the panels

Attach grippers with cables to the Tri/Bi Joints and slide them into the clips on the panels until the click (D). Continue attaching neighbor panels until complete.

Plateau Ceiling System

Optional Spot Lights

Each Plateau ARCHISONIC® PET ceiling panel is pre-cut with the central circular opening. The panel is not cut through entirely so the opening is not visible from the bottom side unless the cutout cilider is pushed out. We recommend performing a light analysis for your space in order to specify the right quantity and location of spot light elements.

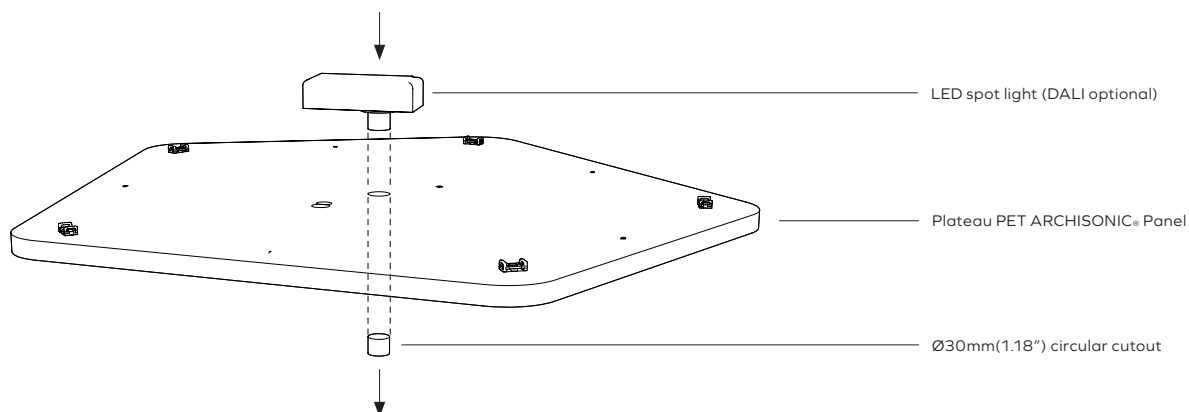

LIGHTING SPECIFICATIONS

per spot light

Output	Direct Only
Total Lumen Output (lm)	328
Wattage	6.5
Efficacy (lm/W)	50.5
Diffuser	Microprism
Beam Angle	34
CCT	2700-3000-3500-4000K
CRI	90+
MacAdam	3
Dimming (optional)	0-10V 0.1% DSI/DALI
Driver Location	On-Board

LIGHT DISTRIBUTION GRAPH

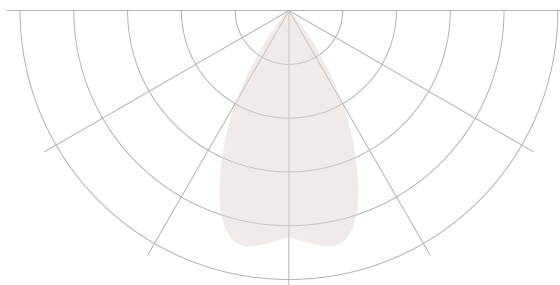











CERTIFICATIONS











ARCHISONIC® Felt Colours

 Material brochure available

									
Name	Snow White	Milk	Cloud	Gull	Smoke	Ground	Charcoal	Slate	Raven
Code	500	404	103	144	442	108	542	444	550
NCS	S 0300-N	S 0502-Y	S 1002-B	S 2502-Y	S 3005-R80B	S 5005-Y20R	S 7502-B	S 4500-N	S 8500-N

									
Name	Nordic Pine	Grove	Fern	Moss	Spearmint	Ice Blue	Succulent	Deep Sea	True Navy
Code	311	317	180	439	706	304	712	918	194
NCS	S 5030-G10Y	S 7020-G30Y	S 6010-G90Y	S 2040-G40Y	S 1010-B90G	S 0510-B	S 3020-B30G	S 5020-R90B	S 8005-B

									
Name	Lichen	Linen	Shell Pink	Jute	Warm Stone	Terracotta	Soft Coral	Honeycomb	Sunshine
Code	160	107	102	920	105	239	516	139	846
NCS	S 4005-Y	S 1505-Y30R	S 0510-R30B	S 3010-Y30R	S 3010-Y50R	S 4040-Y70R	S 2020-Y90R	S 2050-Y20R	S 1040-Y10R

									
Name	Garnet	Hot Pink	Poster Red	Electric Orange	Winter Sky	Pacific Ocean	Midnight	Grape	Marine Blue
Code	724	140	662	464	410	432	810	540	864
NCS	S 5040-R10B	S 2060-R20B	S 1080-R	S 0580-Y70R	S 2020-R90 B	S 3040-B	S 7020-R70B	S 5040-R40B	S 4050-R70B

These NCS codes are the closest visual match available and may not be exact to blended fibres.

ARCHISONIC®

Colours

Experience our ARCHISONIC® Felt material with a stunning selection of 36 colours across 8 distinct families, thoughtfully curated by *Colour Hive* in London. Effortlessly combine colours harmoniously to suit your preferences. Discover more in our Materials brochure and order your free sample box today.

Colour fastness

Class 6

ISO 105-B02:A1

Order a free sample box



ARCHISONIC® Felt Material Specification

Product Name	ARCHISONIC® Felt	
Content	100% PET (60% certified post-consumer content)	
Thickness¹	12mm (0.47")	24mm (0.94")
Max. Size	1200x2800mm (47"x110")	1800x2400mm (70"x94")
Acoustic²	ASTM: NRC=0.6 ISO: α_w =0.65	ASTM: NRC=0.9 ISO: α_w =0.95
Density¹	2400 g/m ² (0.49 lbs/ sqft)	4000 g/m ² (0.82 lbs/sqft)
Colour Fastness	Class 6 ISO 105-B02:A1	
Colour	36 colours (see ARCHISONIC® Felt Colour page for more information)	
Maintenance	For daily cleaning we recommend alcohol solution (75%), e.g. Pantasept. In case of contamination by dust or fluff, use feather duster or a regular vacuum cleaner. For heavy dirt, treat the material with hydrogen peroxide.	
Production Lead time³	21 days	
Fire Rating	DIN EN 13501-1: B-s1, d0	ASTM E84 Class A
VOC Emission	28 Days French Regulation A+ ASTM E84 Pass Bream® (International, UK, NL, SE, NOR) Exemplary CDPH (CDPH/EHLB/Standard Method V1.2) Pass	
Certifications	Declare label, Cradle to Cradle, UL Environmental Product Declaration, Member of US Green Building Council, Ecobau 1st Priority, Climmate-KIC, VOC emissions in LEED EQ credit (low-emitting products), SCS Recycled Content	
Durability	Contract	

1 - all values are nominal 2 - measured with 300mm air cavity 3 - depending on the location and type of product



Climate-KIC is supported by the EIT, a body of the European Union



Declare.

DANAK
TEST Reg.nr. 522



Plateau Ceiling System

Acoustic Performance



Testing Standards

ISO 354:2003	Acoustics — Measurement of sound absorption in a reverberation room
ISO 11654:1997	Acoustics — Sound absorbers for use in buildings — Rating of sound absorption
ASTM C423-17	Standard Test Method for Sound Absorption and Sound Absorption Coefficients by the Reverberation Room Method

Test Results

Thickness	Distance to Ceiling	α_w	SAA	NRC
24mm	200mm	0.75 (MH)	0.85	0.85

The NRC rating is calculated as the average of the absorption coefficients measured at frequencies of 250Hz, 500Hz, 1000Hz and 2000Hz and round to the nearest 0.05. SAA rating is calculated as the average of the sound absorption coefficients of a material for the twelve one-third octave bands from 200Hz through 2500Hz and rounded off to the nearest 0.01.

Practical Sound Absorption Coefficient, α_p

Thickness	Distance to Ceiling	125Hz	250Hz	500Hz	1000Hz	2000Hz	4000Hz
24mm	200mm	0.05	0.45	0.85	1.00	1.00	1.00

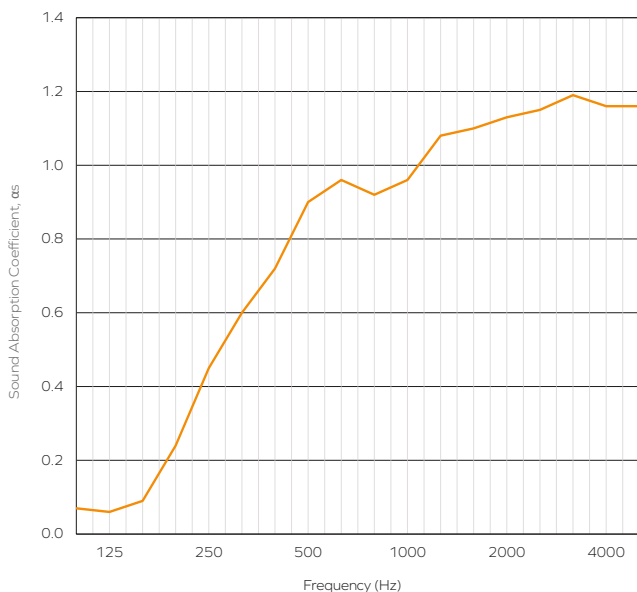

● 24mm Plateau, 300mm Distance to Ceiling

The table represents the practical sound absorption coefficient (α_p) in accordance with ISO 11654. The graph represents the sound absorption coefficients (α_s) in the third octave band center frequencies in accordance with ISO 354. Measurement used Pink Noise as excitation signal in a reverberant room.

Plateau Ceiling System

Reference Project

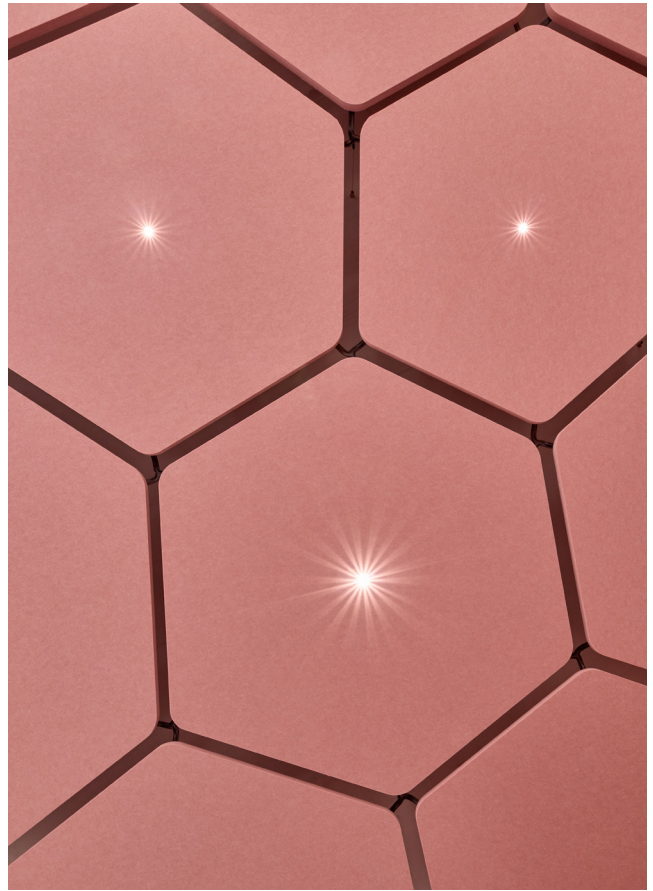

Plateau Ceiling System

Additional Information

Online Resources

A variety of resources are available online for all of our products. Please visit the product's page for more information.



CAD files



Spec sheets and
Installation Guide



Colour families



Instruction
videos



Associated
products specs.

Ordering Process

Our experienced team of Project Consultants will guide and support you throughout the order process. We fulfill the majority of our orders in as little as 21 days¹ from your first point of contact, allowing you to focus on what truly matters to you.



Contact our
consultant

Quote¹

48h



Order Confirmation

Production¹

14-21 days



Dispatch

Transit

location based



Delivery

Contact Us

Ready to make an impact? We are just an email or call away to discuss your project and answer any question.



+41 41 244 14 00



connect@impactacoustic.com



Online form

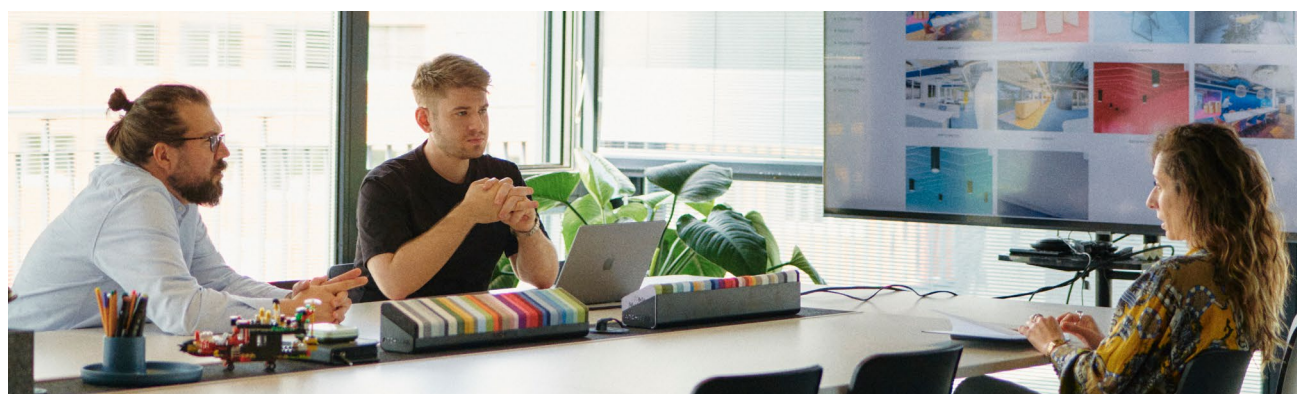

¹ - Quote and Production times may vary.

**#We
Make An
Impact**

connect@impactacoustic.com | www.impactacoustic.com