

Balken

Volumetric Baffles

716.12.10.000.00	716.12.13.000.00	716.12.12.000.95
716.12.11.000.00	716.12.14.000.00	716.12.15.000.95
716.12.12.000.00	716.12.15.000.00	716.12.22.000.95
716.12.20.000.00	716.12.23.000.00	716.12.25.000.95
716.12.21.000.00	716.12.24.000.00	
716.12.22.000.00	716.12.25.000.00	

Balken Volumetric Baffle

General Information



Data

Applicable article numbers

ARCHISONIC® Felt		ARCHISONIC® Riftcut	
716.12.10.000.00	716.12.20.000.00	716.12.13.000.00	716.12.23.000.00
716.12.11.000.00	716.12.21.000.00	716.12.14.000.00	716.12.24.000.00
716.12.12.000.00	716.12.22.000.00	716.12.15.000.00	716.12.25.000.00
ARCHISONIC® Felt Lit version		ARCHISONIC® Riftcut Lit version	
716.12.12.000.95	716.12.22.000.95	716.12.15.000.95	716.12.25.000.95

Single element dimensions¹

Height Options	77, 127, 227 (mm)	3", 5", 9"
Standard Length Options	1400, 2800 (mm)	55", 110"
Standard Width	80 (mm)	3 1/8"

Material

Baffles	100% PET (60% post-consumer)
Hardware	Aluminium, Steel

Weight²

ARCHISONIC® Felt	4kg/m ² (±10%)	0.8 lbs/ft ² (±10%)
------------------	---------------------------	--------------------------------

Included

Volumetric baffles

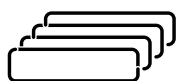

Assembly Hardware

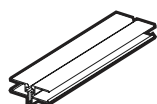

Installation Hardware⁴



Installation guide



Warranty 10 years³



1 - all dimensions are nominal 2 - all weight values are nominal 3 - Impact Acoustic warranty terms apply 4 - sold separately, see page 3

Balken Volumetric Baffle

Specification Guide

Ensure you make the perfect choice by choosing our solutions for your next project. To get started, simply define some basic information and constraints about your space. Then explore our range of standard solutions or contact us directly for a more in-depth discussion of personalized options.

1 Prepare this information:

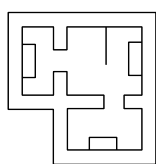

Project Area

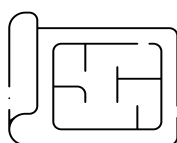

Ceiling Plans (RCP)

page 7



Other Considerations

page 7

2 Specify your volumetric baffles:



Height

page 4

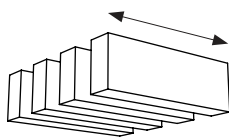

Length

page 4

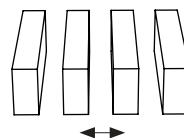

Spacing

page 5-6

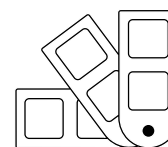

Colour and
Texture

page 15 and 16

3 Select installation method:

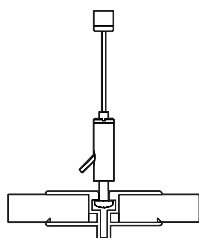

Cable to
ceiling

716.10.10.000.00

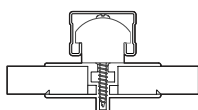

Felt-Fix to
strut channel

716.10.20.000.00

Not applicable for Balken Light

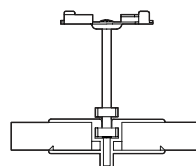

T-Grid Clip to
T-grid

716.10.30.000.00

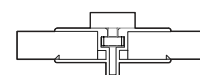

Magnet to
ceiling

716.10.40.000.00

Not applicable for Balken Light

Balken Volumetric Baffle

Geometry Information

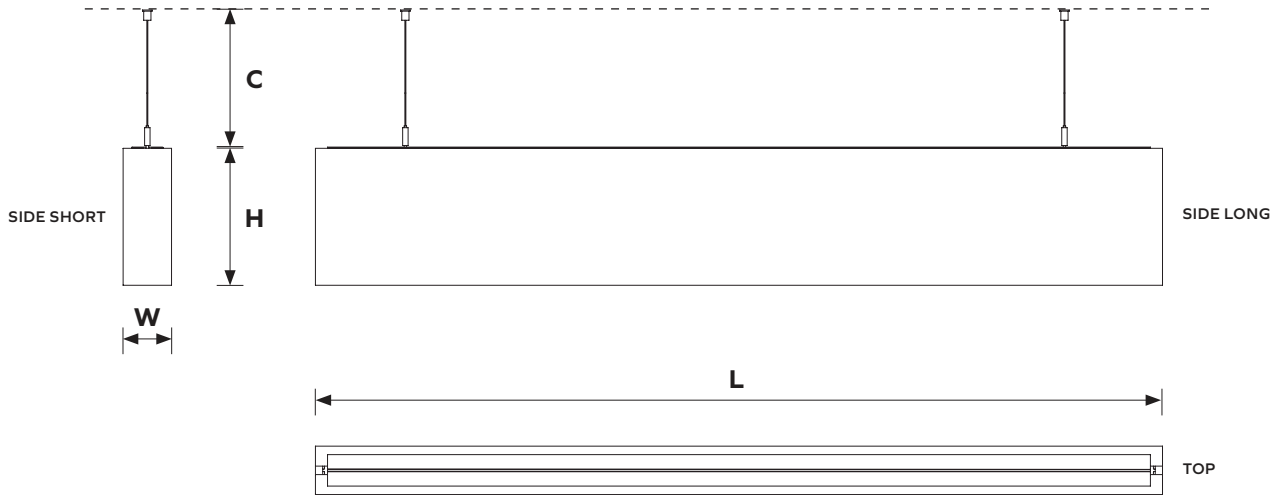

Dimension tables ¹

Name	Balken S	Balken M	Balken L
Code (Regular)	716.12.10.000.00	716.12.11.000.00	716.12.12.000.00
Code (Riftcut)	716.12.13.000.00	716.12.14.000.00	716.12.15.000.00
L Length	1400mm 55"	1400mm 55"	1400mm 55"
W Width	80mm 3 1/8"	80mm 3 1/8"	80mm 3 1/8"
H Height	77mm 3"	127mm 5"	227mm 9"
C Clearance	50-1500mm (2-59") depending on installation method - see page 3		

Name	Balken SL	Balken ML	Balken LL
Code (Regular)	716.12.20.000.00	716.12.21.000.00	716.12.22.000.00
Code (Riftcut)	716.12.23.000.00	716.12.24.000.00	716.12.25.000.00
L Length	2800mm 110"	2800mm 110"	2800mm 110"
W Width	80mm 3 1/8"	80mm 3 1/8"	80mm 3 1/8"
H Height	77mm 3"	127mm 5"	227mm 9"
C Clearance	50-1500mm (2-59") depending on installation method - see page 3		

¹ all values are nominal

Balken Volumetric Baffle

Product Family Overview

1 Balken S, M, L (1400)



Customizable product

716.12.10.000.00 - Balken S (ARCHISONIC® Felt) 716.12.13.000.00 - Balken S (ARCHISONIC® Riftcut)

Picture shows 2 sets = 16 elements
Spacing between elements: 80mm (3 1/8") F2F
1 set = 8 elements

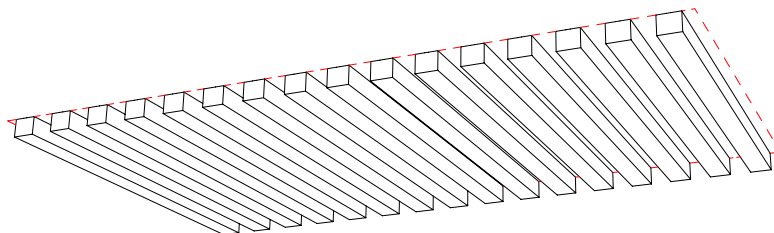

716.12.11.000.00 - Balken M (ARCHISONIC® Felt) 716.12.14.000.00 - Balken M (ARCHISONIC® Riftcut)

Picture shows 2 sets = 12 elements
Spacing between elements: 133mm (5 1/4") F2F
1 set = 6 elements

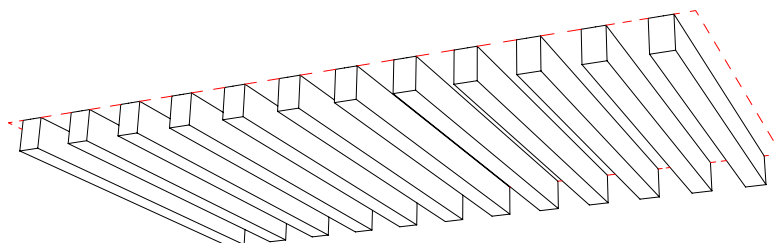

716.12.12.000.00 - Balken L (ARCHISONIC® Felt) 716.12.15.000.00 - Balken L (ARCHISONIC® Riftcut)

Picture shows 2 sets = 8 elements
Spacing between elements: 240mm (9 1/2") F2F
1 set = 4 elements

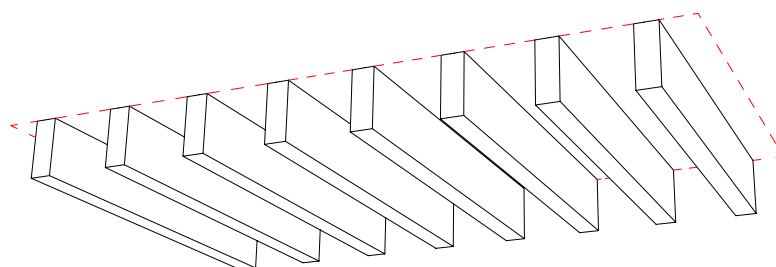

¹ all dimensions are nominal

Balken Volumetric Baffle

Product Family Overview

2 Balken SL, ML, LL (2800)



716.12.20.000.00 - Balken SL (ARCHISONIC® Felt)

716.12.23.000.00 - Balken SL (ARCHISONIC® Riftcut)

Picture shows 2 sets = 8 elements
Spacing between elements: 80mm (3 1/8") F2F
1 set = 4 elements

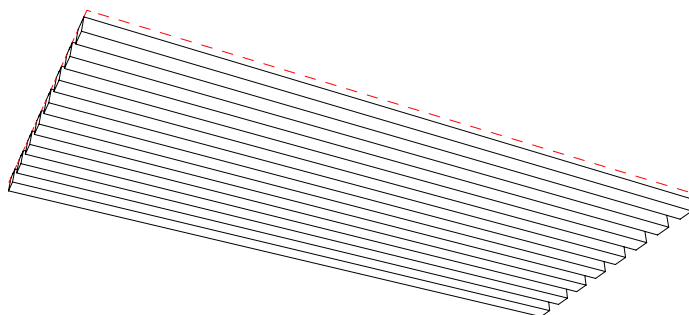

716.12.21.000.00 - Balken ML (ARCHISONIC® Felt)

716.12.24.000.00 - Balken ML (ARCHISONIC® Riftcut)

Picture shows 2 sets = 6 elements
Spacing between elements: 133mm (5 1/4") F2F
1 set = 3 elements

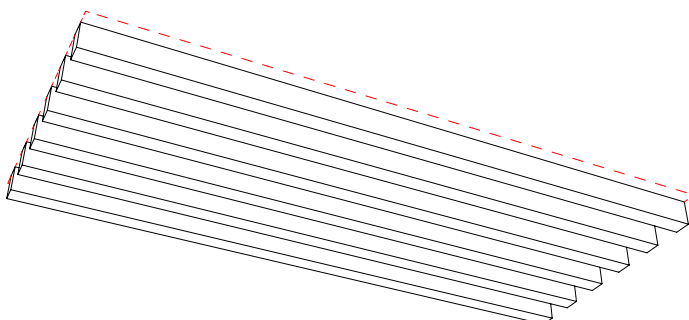

716.12.22.000.00 - Balken LL (ARCHISONIC® Felt)

716.12.25.000.00 - Balken LL (ARCHISONIC® Riftcut)

Picture shows 2 sets = 4 elements
Spacing between elements: 240mm (9 1/2") F2F
1 set = 2 elements

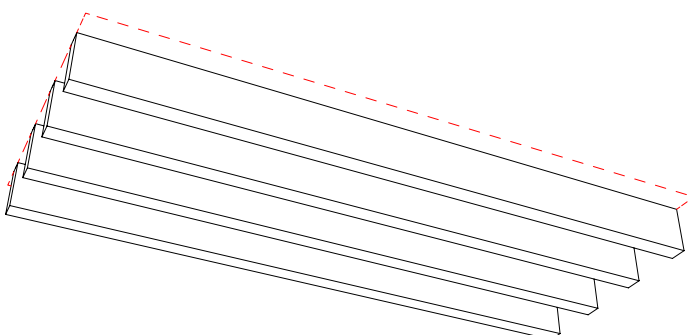

¹ all dimensions are nominal

Balken Volumetric Baffle

Planning Considerations

 Extended document available

When planning the addition of a Bespoke Ceiling Baffle System to your space, please consider the following aspects.

1 Project Area

Check and verify the project area where the Balken will be installed. This will allow us to provide you with an accurate quote.

2 Reverse Ceiling Plans

Verify if RCP drawings for the space are available. This will help plan for any obstacles like columns and air-ducts that might collide with the Balken elements.

3 Additional considerations

Consider access to high windows and doors.

Verify the type of material to which the support elements will be mounted.

Plan for providing min. 100mm (4") safe space distance from Balken to other elements

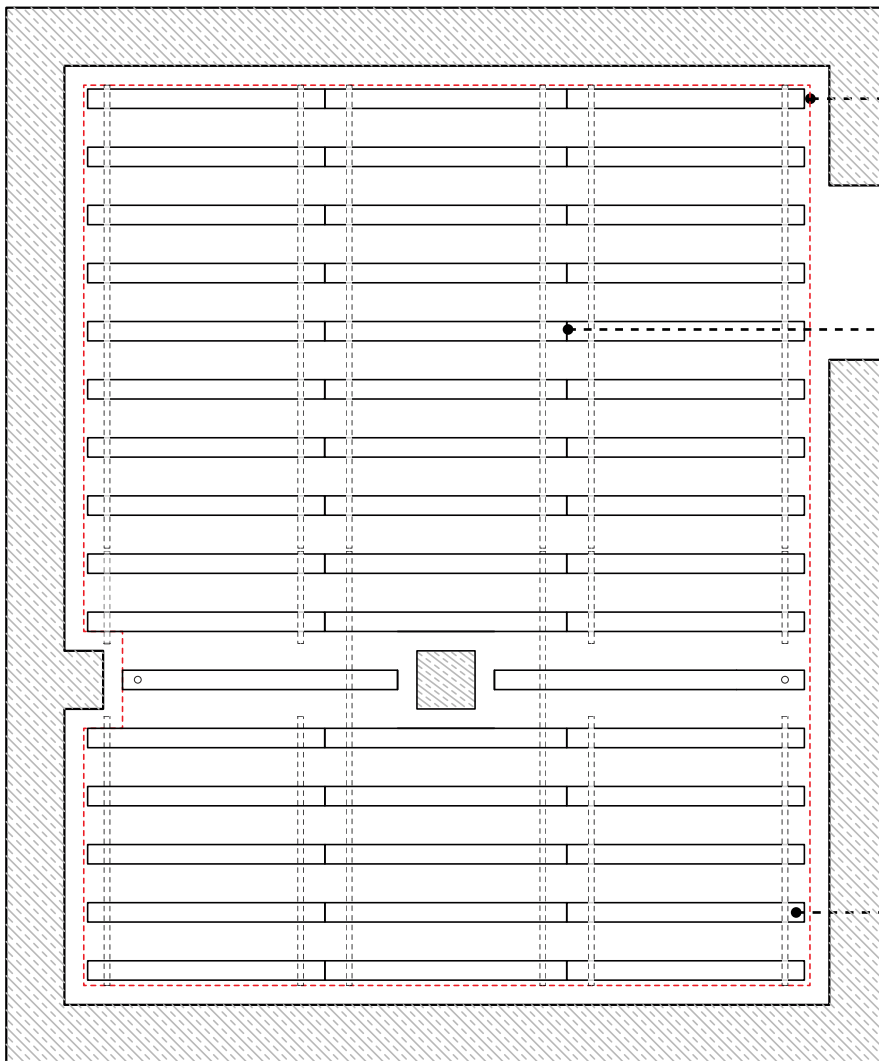

RCP drawing example

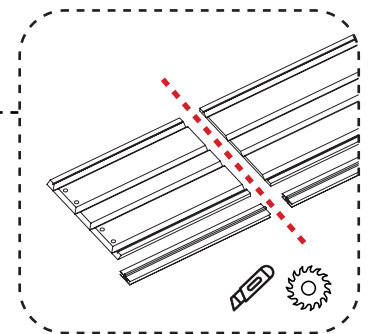
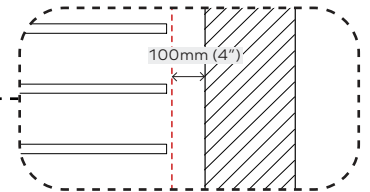

Balken can be cut on site using carpentry knife. The aluminum profiles can also be trimmed using rotary circular saw for wood.

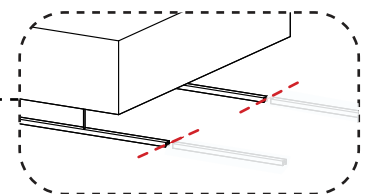

Strut tracks can be cut on site using steel rotary cutter, angle grinder or similar power tool.

Balken Volumetric Baffle

Assembly Overview

 Extended document available

1 Assemble the endcaps

Install the Endcap clips into the Endcap Felt elements using provided screws. Endcaps are sold separately.

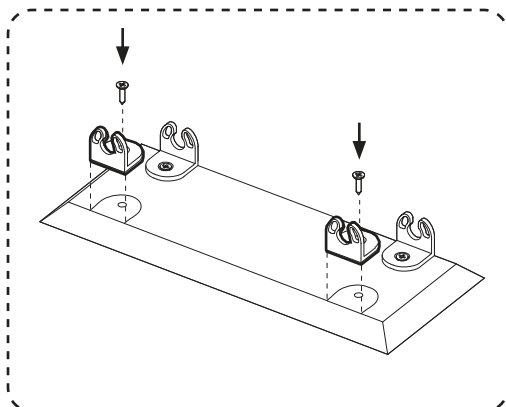

Endcap S - Regular	716.10.51.000.00
Endcap M - Regular	716.10.52.000.00
Endcap L - Regular	716.10.53.000.00
Endcap S - Riftcut	716.12.51.000.00
Endcap M - Riftcut	716.12.52.000.00
Endcap L - Riftcut	716.12.53.000.00

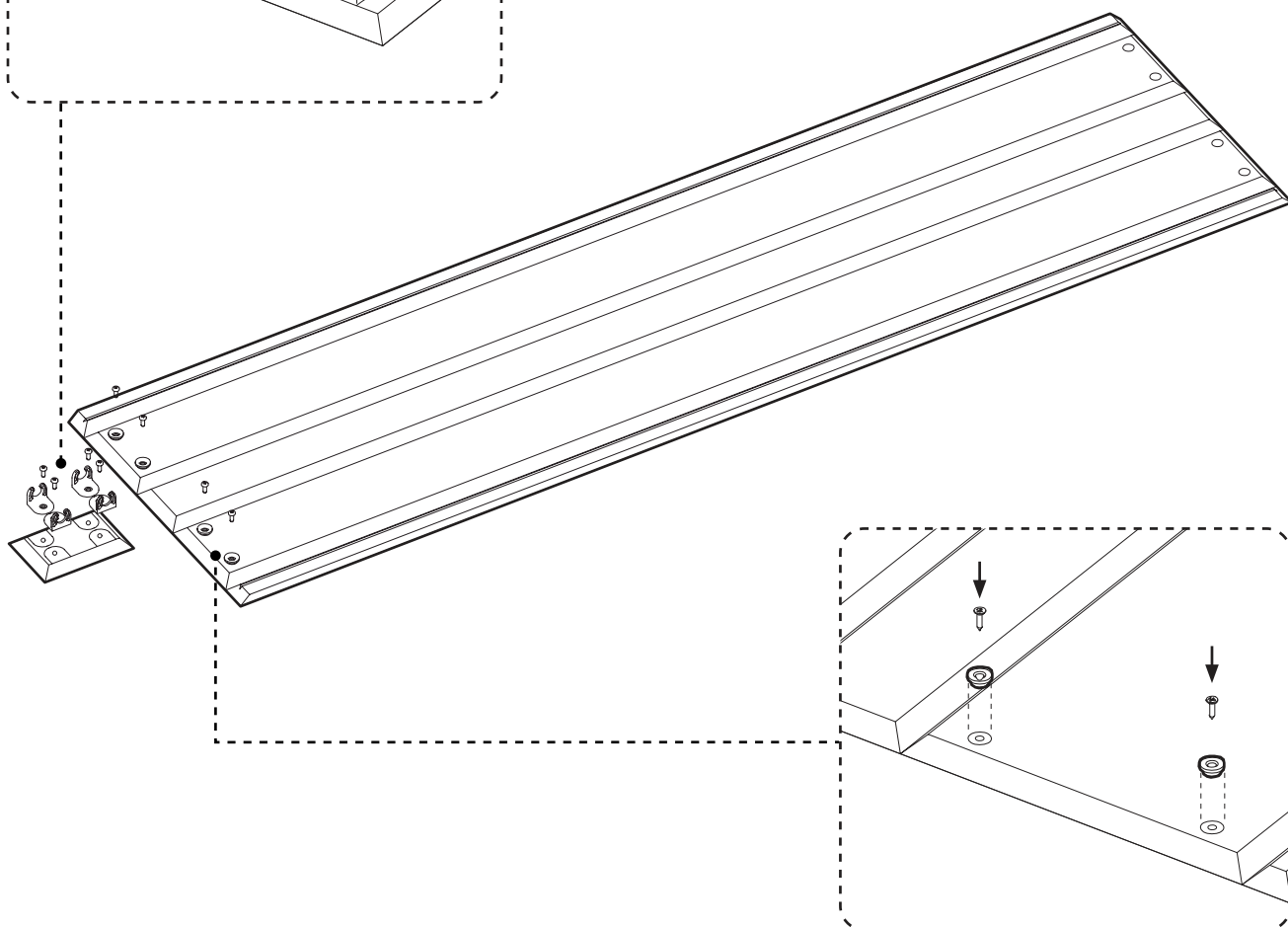

2 Install Endcap Clip buttons

Install the Endcap Clip buttons on unfolded Balken baffle in the marked spaces. This applies only to the last Balken in the Balken row, unless specified otherwise.

Balken Volumetric Baffle

Assembly Overview

 Extended document available

3 Fold the baffle and slide in the center profile

Fold the flat felt element into volumetric baffle and join in by sliding the center profile into the middle.

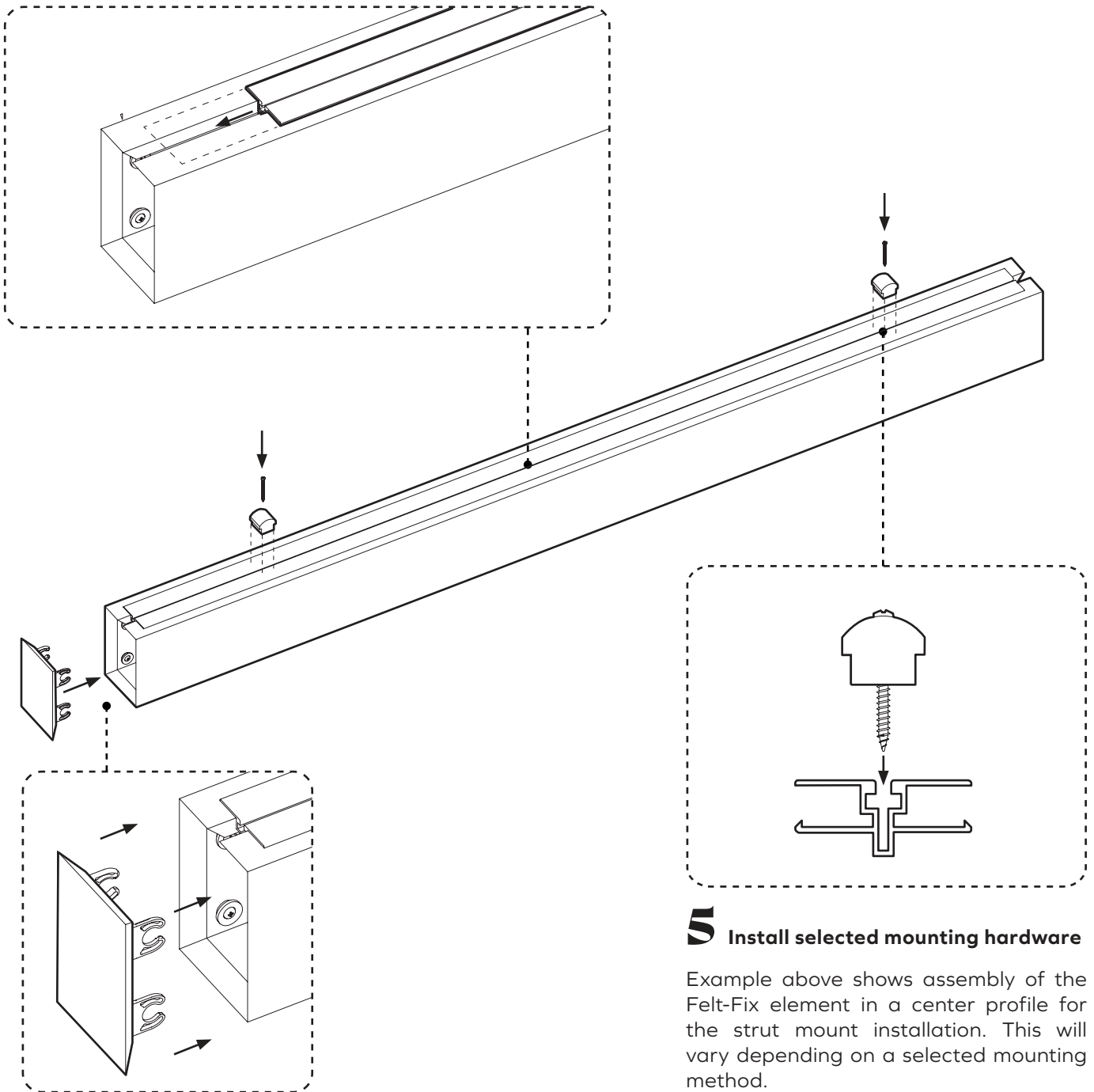

4 Install End Cap (if applicable)

End Caps are optional items used to closed last open Balken edge in a row.

5 Install selected mounting hardware

Example above shows assembly of the Felt-Fix element in a center profile for the strut mount installation. This will vary depending on a selected mounting method.

Balken Volumetric Baffle

Assembly Overview

 Extended document available

1 Install the balken using strut channel installation

Assembled Balken can be attached to strut channels but pushing the Fel-Fix elements into the struts as showed on figure 2. Extended step-by-step assembly and installation guide, showing different installation methods is available as separate document and can be downloaded from our website..

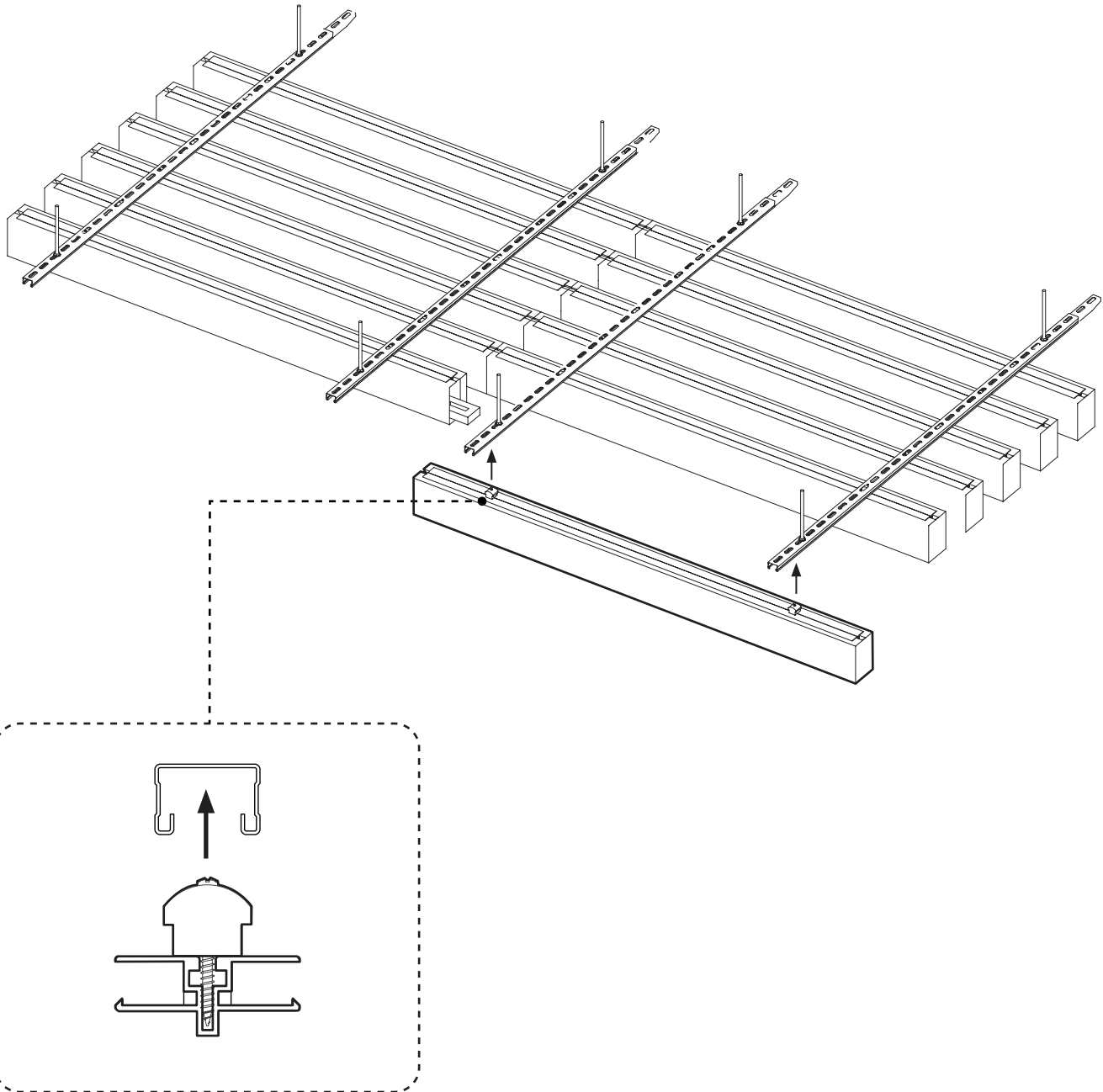

figure 2. Fel-Fix to Strut installation.

Balken Light

Product Overview

Efficient and Flexible

We are using flexible light track system that allows for **plug-and-play** operation of selected light emitters. All light sources are mounted simply by clicking them into the track, without the need for any tools or wiring .

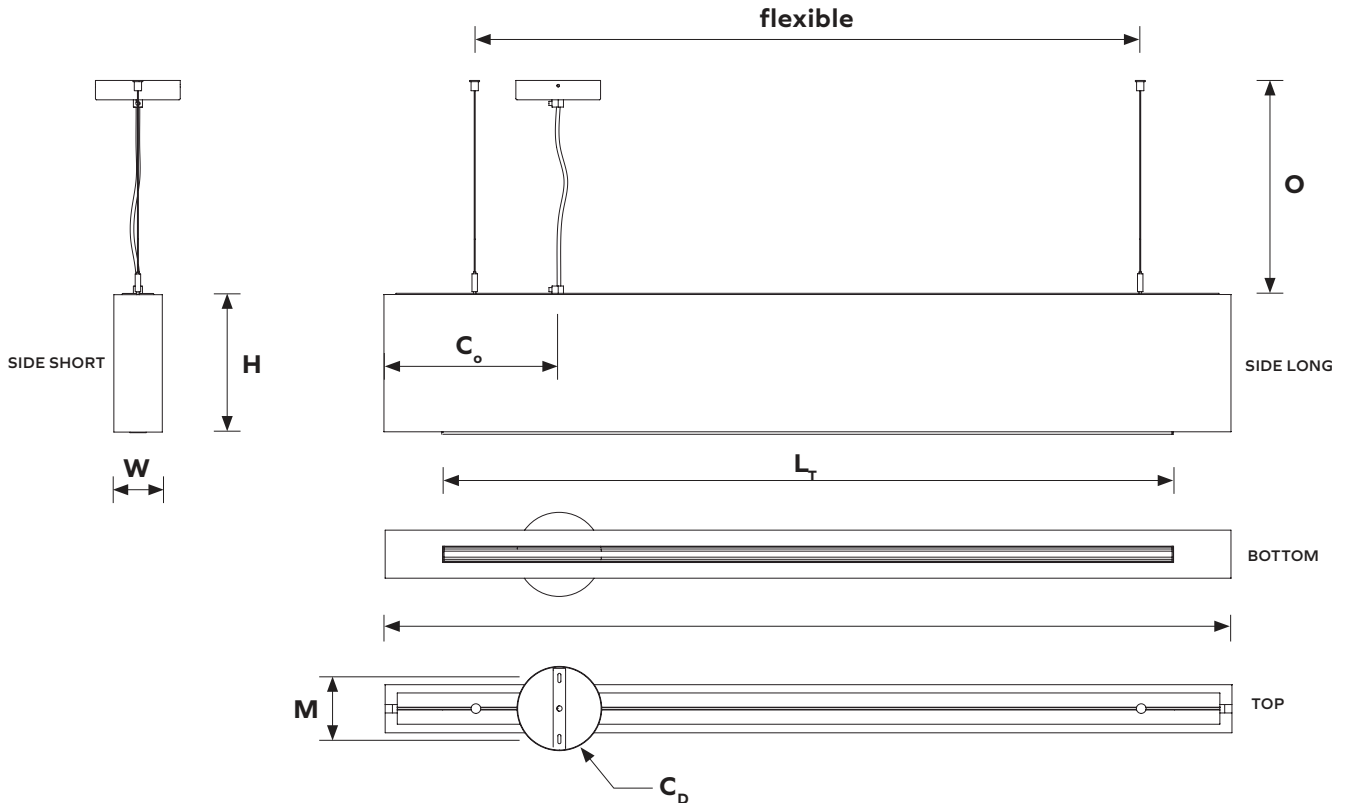

Dimension table ¹

Type	Balken L - Lit		Balken LL - Lit	
	ARCHISONIC® Felt	ARCHISONIC® Riftcut	ARCHISONIC® Felt	ARCHISONIC® Riftcut
Product Number	716.12.12.000.95	716.12.15.000.95	716.12.22.000.95	716.12.25.000.95
L Total Length	1400mm	55"	2800mm	110"
W Total Width	80mm	3"	80mm	3"
H Baffle Height	227mm	9"	227mm	9"
L_t Length Tracklight	1200mm	47 1/4"	2400mm	94 1/2"
O Offset	300-1500mm	12-60"	300-1500mm	12-60"
C_L Cable Length	max. 3200mm	max. 125"	max. 3200mm	max. 125"
C_D Canopy Diameter	140mm	5 1/2"	140mm	5 1/2"
C_o Cable Offset	100mm	4"	100mm	4"
M Mount Spacing	90mm	3 1/2"	90mm	3 1/2"
Canopy Colour	Matte Black RAL 9005			
Cable Colour	Matte Black RAL 9005			

¹ all dimensions are nominal

Balken Light

Product Family Overview

1 Balken Light LL (2800)

716.12.22.000.95 - Balken LIGHT LL 716.12.25.000.95 - Balken LIGHT LL Riftcut

Specific light emitters are sold separately and can be easily mounted into pre-installed electrified track with ease. See the picture below for example assembly using various light sources. The exact number and output of the light emitters for specific application should be verified with lighting consultant.

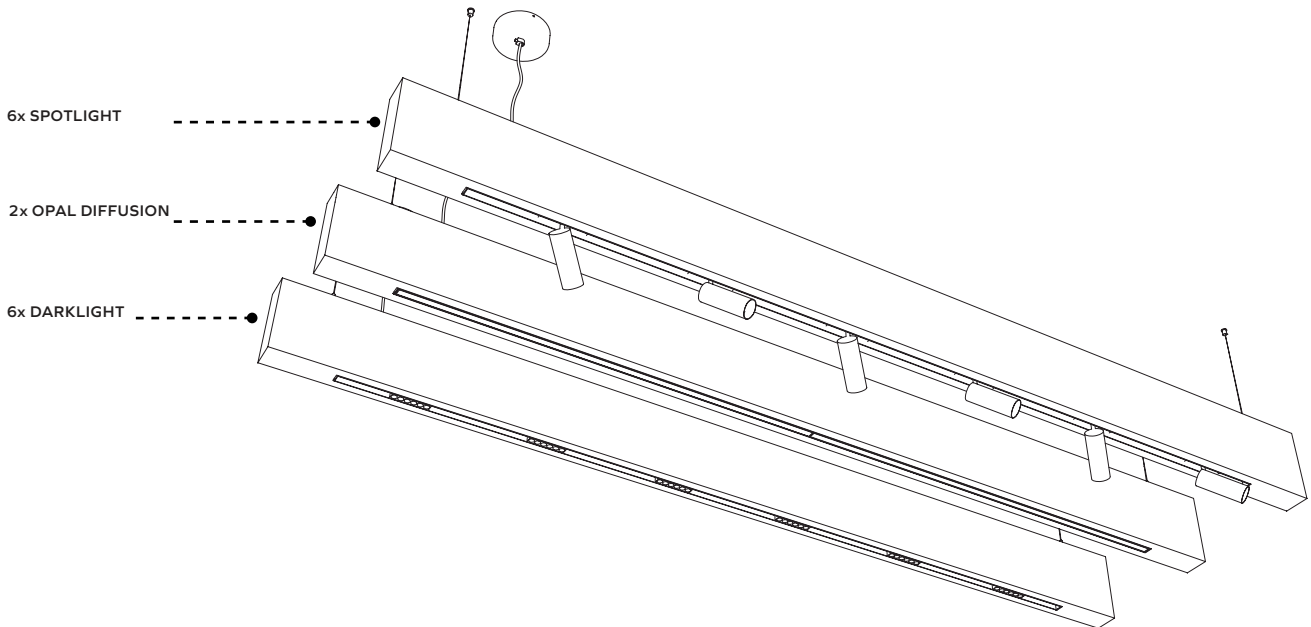

2 Balken Light L (1400)

716.12.12.000.95 - Balken LIGHT L 716.12.15.000.95 - Balken LIGHT L Riftcut

Specific light emitters are sold separately and can be easily mounted into pre-installed electrified track with ease. See the picture below for example assembly using various light sources. The exact number and output of the light emitters for specific application should be verified with lighting consultant.

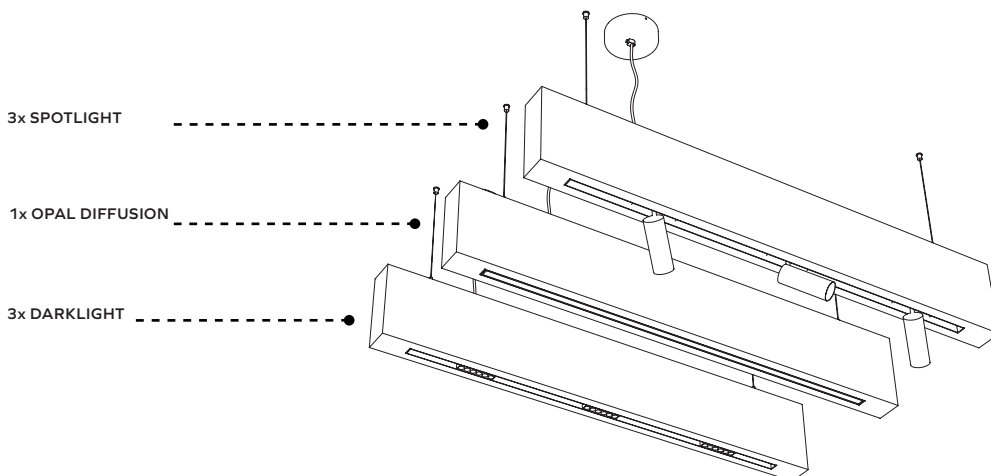

Balken Light

Accessories

Click-In Light Sources

OPAL DIFFUSION

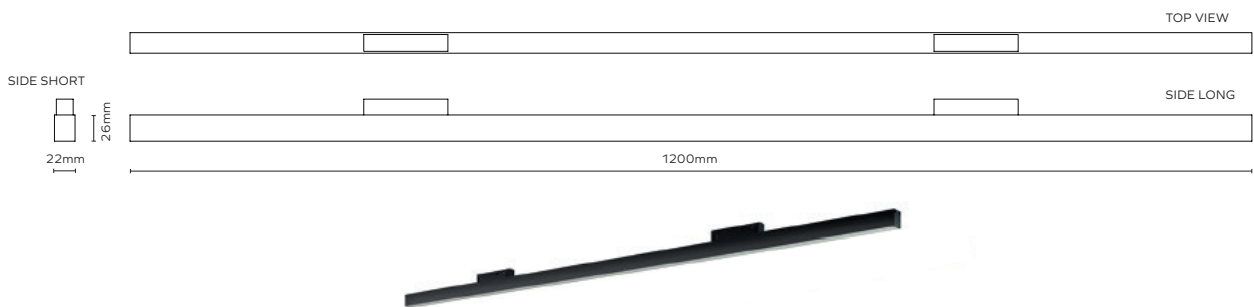

DARKLIGHT

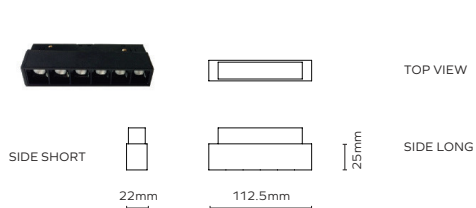

SPOTLIGHT

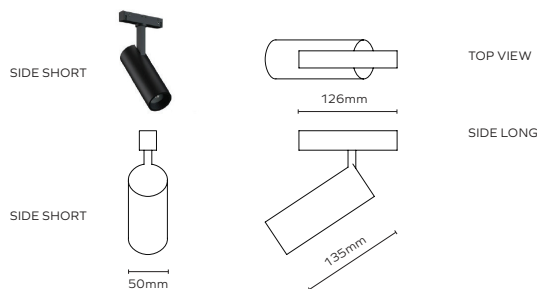

Type	SPOTLIGHT		DARKLIGHT		OPAL DIFFUSION	
Power	10W		6W		28.8W	
Code	LUM.01.00001.30D	LUM.01.00002.40D	LUM.01.00003.30D	LUM.01.00004.40D	LUM.01.00005.30D	LUM.01.00006.40D
CCT	3000K	4000K	3000K	4000K	3000K	4000K
Lumen	901	940	550	583	2861	2940
(Lm/W)	90	94	91	97	100	102
CRI	>90		95		95	
Beam Angle	36°		24°		120°	
Dimming	DALI		DALI		DALI	
Distribution						

¹ all dimensions are nominal

Balken Light

Suggested Applications

1 Linear opal diffusion light

Suggested application: Entrances and transit zones, Halls, Corridors, Diffusion light distribution

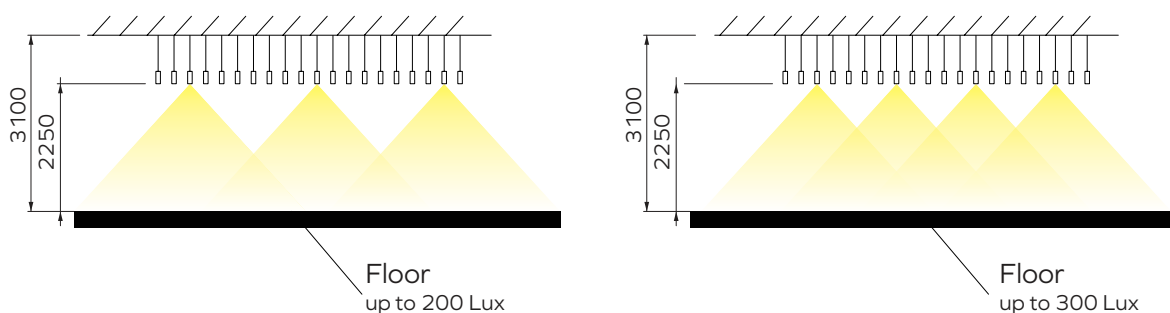

2 Spot lighting

Suggested application: Offices, Downlight, Adjustable light

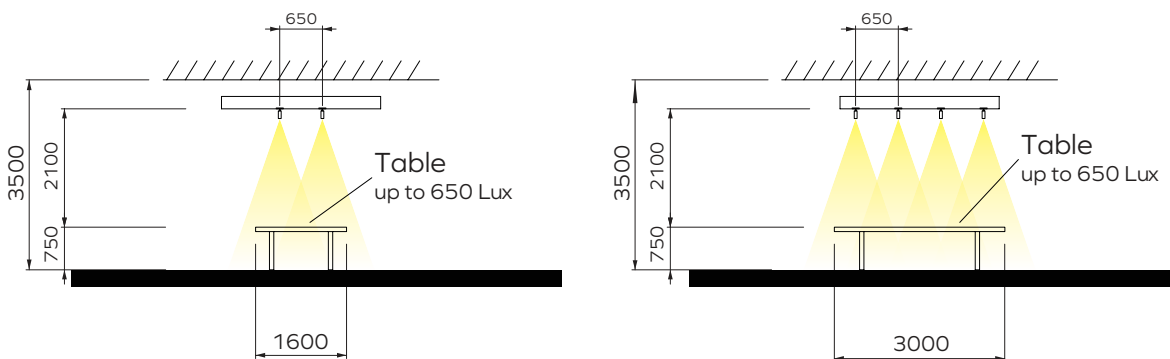





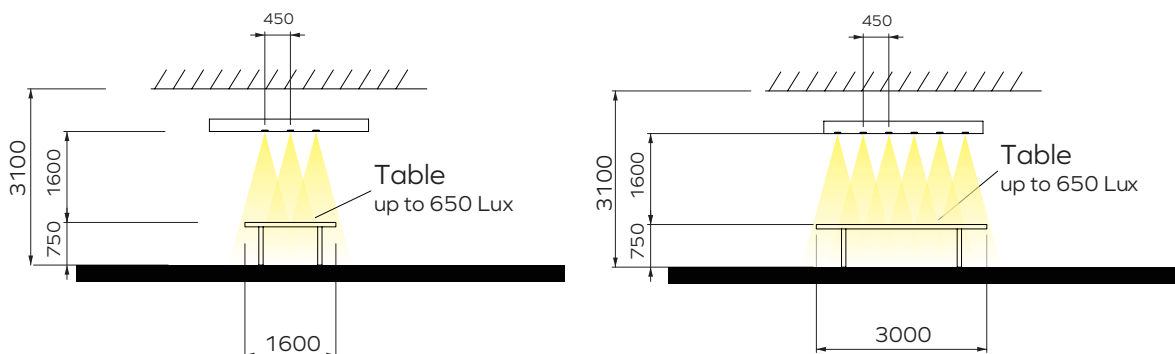





3 Darklight









Suggested application: Tasklight, Focus, Low Glare











ARCHISONIC® Felt Colours

 Material brochure available

									
Name	Snow White	Milk	Cloud	Gull	Smoke	Ground	Charcoal	Slate	Raven
Code	500	404	103	144	442	108	542	444	550
NCS	S 0300-N	S 0502-Y	S 1002-B	S2502-Y	S 3005-R80B	S 5005-Y20R	S 7502-B	S 4500-N	S 8500-N

									
Name	Nordic Pine	Grove	Fern	Moss	Spearmint	Ice Blue	Succulent	Deep Sea	True Navy
Code	311	317	180	439	706	304	712	918	194
NCS	S 5030-G10Y	S 7020-G30Y	S6010-G90Y	S 2040-G40Y	S 1010-B90G	S 0510-B	S 3020-B30G	S 5020-R90B	S8005-B

									
Name	Lichen	Linen	Shell Pink	Jute	Warm Stone	Terracotta	Soft Coral	Honeycomb	Sunshine
Code	160	107	102	920	105	239	516	139	846
NCS	S4005-Y	S 1505-Y30R	S 0510-R30B	S 3010-Y30R	S 3010-Y50R	S 4040-Y70R	S 2020-Y90R	S 2050-Y20R	S 1040-Y10R

									
Name	Garnet	Hot Pink	Poster Red	Electric Orange	Winter Sky	Pacific Ocean	Midnight	Grape	Marine Blue
Code	724	140	662	464	410	432	810	540	864
NCS	S 5040-R10B	S 2060-R20B	S 1080-R	S 0580-Y70R	S 2020-R90 B	S 3040-B	S 7020-R70B	S 5040-R40B	S 4050-R70B

These NCS codes are the closest visual match available and may not be exact to blended fibres.

ARCHISONIC®

Colours

Experience our ARCHISONIC® Felt material with a stunning selection of 36 colours across 8 distinct families, thoughtfully curated by *Colour Hive* in London. Effortlessly combine colours harmoniously to suit your preferences. Discover more in our Materials brochure and order your free sample box today.

Colour fastness

Class 6
ISO 105-B02:A1

Order a free sample box



ARCHISONIC® Riftcut

A Synthesis of Nature and Innovation

Developed in collaboration with German veneer specialists Schotten & Hansen and Swiss designer Ina Rinderknecht, ARCHISONIC® Riftcut adds a natural touch to our acclaimed Felt range.



ARCHISONIC® Riftcut Flax 50

Colour options

The printed shades form the basis of 24 colour spectrum, offering interior designers a sophisticated range of options linked to natural dyes.



Sustainable Ink

CP65 and RoHS3 compliant



Order a free sample set



ARCHISONIC® Riftcut Natural Collection

Natural Collection colour sets

Riftcut Natural Collection (NC) is a natural wood shade extension to our bestselling Riftcut. Developed in collaboration with German veneer specialists Schotten & Hansen, ARCHISONIC® Riftcut NC introduces 3 different colour groups: elegant brights, essential mids and classical darks.



ELEGANT BRIGHTS



240 Pebble

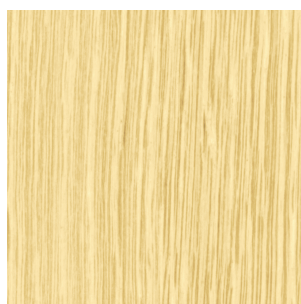

241 Sunlit



242 Blush



ESSENTIAL MIDS



243 Malt

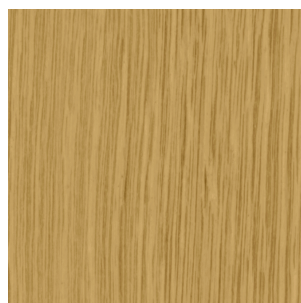

244 Honey

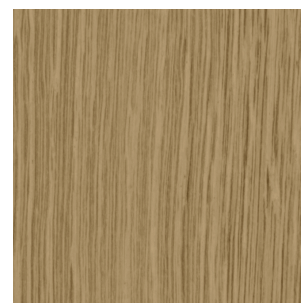

245 Mocha



CLASSICAL DARKS



246 Woodsmoke



247 Bourbon



248 Twilight

Sustainable Ink

CP65 and RoHS3 compliant



Order a free sample set



ARCHISONIC® Felt (Printed option)

Material Specification

Product Name	ARCHISONIC® Felt	
Content	100% PET (60% certified post-consumer content)	
Thickness¹	12mm (0.47")	
Max. Size	1200x2800mm (47"x110")	
Acoustic^{2, 4}	ASTM: NRC=0.6 ISO: α_w =0.65	
Density¹	2400 g/m ² (0.49 lbs/ sqft)	
Colour	33 printed finishes.	
Maintenance	To prevent dust and stains, regularly dust or vacuum with a soft brush. Avoid tools that might scratch the surface. Use mild detergents sparingly for tough stains, blotting instead of rubbing with a microfiber cloth. Test cleaning methods on a hidden area first to check for adverse effects.	
Lead Time^{3, 4}	21 days	
Fire Rating⁴	DIN EN 13501-1: B-s1, d0	ASTM E84 Class A
VOC Emission⁴	28 Days French Regulation A+ ASTM E84 Pass Bream® (International, UK, NL, SE, NOR) Exemplary CDPH (CDPH/EHLB/Standard-Method V1.2) Pass	
Certifications⁴	Declare label, Cradle to Cradle, UL Environmental Product Declaration, Member of US Green Building Council, Ecobau 1st Priority, Climmate-KIC, VOC emissions in LEED EQ credit (low-emitting products), SCS Recycled Content	
Ink Certifications	UL Greenguard, No NVC, No VOCs, No TPO, Vegan, compliant with California Prop65 (CP65) and European Directive RoHS3	
Durability	Contract	

1 - all values are nominal 2 - measured with 300mm air cavity 3 - depending on the location and type of product



Balken Volumetric Baffle

Acoustic Performance



Testing Standards

ISO 354:2003	Acoustics — Measurement of sound absorption in a reverberation room
ISO 11654:1997	Acoustics — Sound absorbers for use in buildings — Rating of sound absorption
ISO 20189:2018	Acoustics — Screens, furniture and single objects intended for interior use — Rating of sound absorption and sound reduction of elements based on laboratory measurements
ASTM C423-17	Standard Test Method for Sound Absorption and Sound Absorption Coefficients by the Reverberation Room Method
ASTM E795-16	Standard Practices for Mounting Test Specimens During Sound Absorption Tests

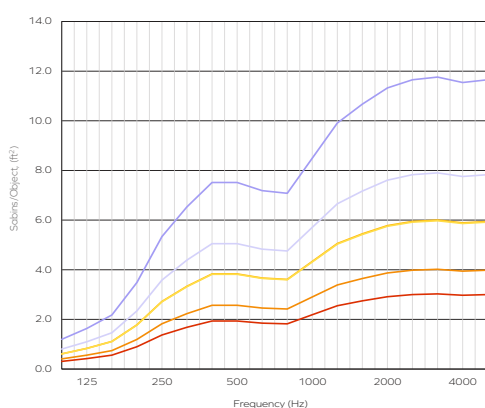

Acoustic Performance - ASTM Sabins , ft²

Frequency (Hz)	125	250	500	1000	2000	4000
Balken S	0.01	1.08	2.15	2.15	3.23	3.23
Balken M	1.08	2.15	2.15	3.23	4.31	4.31
Balken L	1.08	2.15	4.31	4.31	5.38	6.46
Balken SL	1.08	2.15	3.23	4.31	5.38	5.38
Balken ML	1.08	3.23	5.38	5.38	7.53	7.53
Balken LL	2.15	5.38	7.53	8.61	10.76	11.84

The graph represents the Sabins (ft²) in the third octave band center frequencies in accordance with ASTM C423.

● Balken S ● Balken M ● Balken L ● Balken SL ● Balken ML ● Balken LL

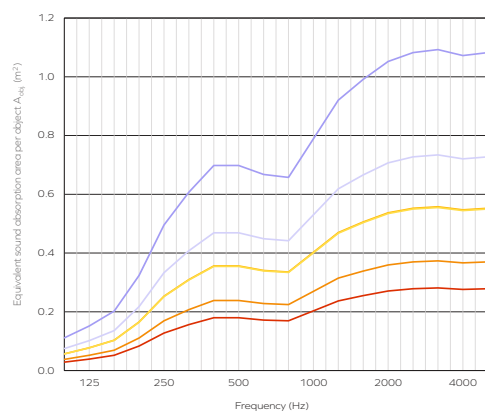

Acoustic Performance - ISO A_{obj} , m²

Frequency (Hz)	125	250	500	1000	2000	4000
Balken S	0.1	0.1	0.2	0.2	0.3	0.3
Balken M	0.1	0.2	0.2	0.3	0.4	0.4
Balken L	0.1	0.2	0.4	0.4	0.5	0.6
Balken SL	0.1	0.2	0.3	0.4	0.5	0.5
Balken ML	0.1	0.3	0.5	0.5	0.7	0.7
Balken LL	0.2	0.5	0.7	0.8	1.0	1.1

The graph represents the equivalent sound absorption coefficient per baffle object (A_{obj}) in the third octave band center frequencies in accordance with ISO 20189. Measurement used Pink Noise as excitation signal in a reverberant room.

● Balken S ● Balken M ● Balken L ● Balken SL ● Balken ML ● Balken LL

Balken Volumetric Baffle

Additional Information

Online Resources

A variety of resources are available online for all of our products. Please visit the product's page for more information.



CAD files



Spec sheets and
Installation Guide



Colour families



Instruction
videos



Associated
products specs.

Ordering Process

Our experienced team of Project Consultants will guide and support you throughout the order process. We fulfill the majority of our orders in as little as 21 days¹ from your first point of contact, allowing you to focus on what truly matters to you.



Contact our
consultant

Quote¹

48h



Order Confirmation

Production¹

14-21 days



Dispatch

Transit

location based



Delivery

Contact Us

Ready to make an impact? We are just an email or call away to discuss your project and answer any question.



+41 41 244 14 00



connect@impactacoustic.com



Online form

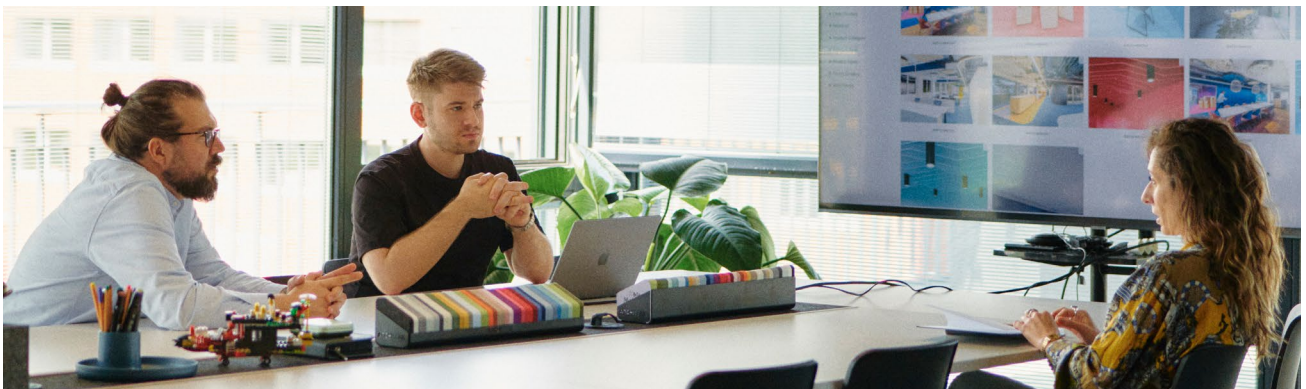

¹ - Quote and Production times may vary.

**#We
Make An
Impact**

connect@impactacoustic.com | www.impactacoustic.com