

IMPACT ACOUSTIC®

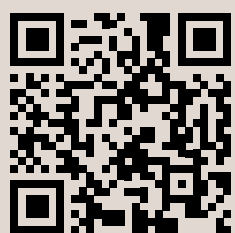
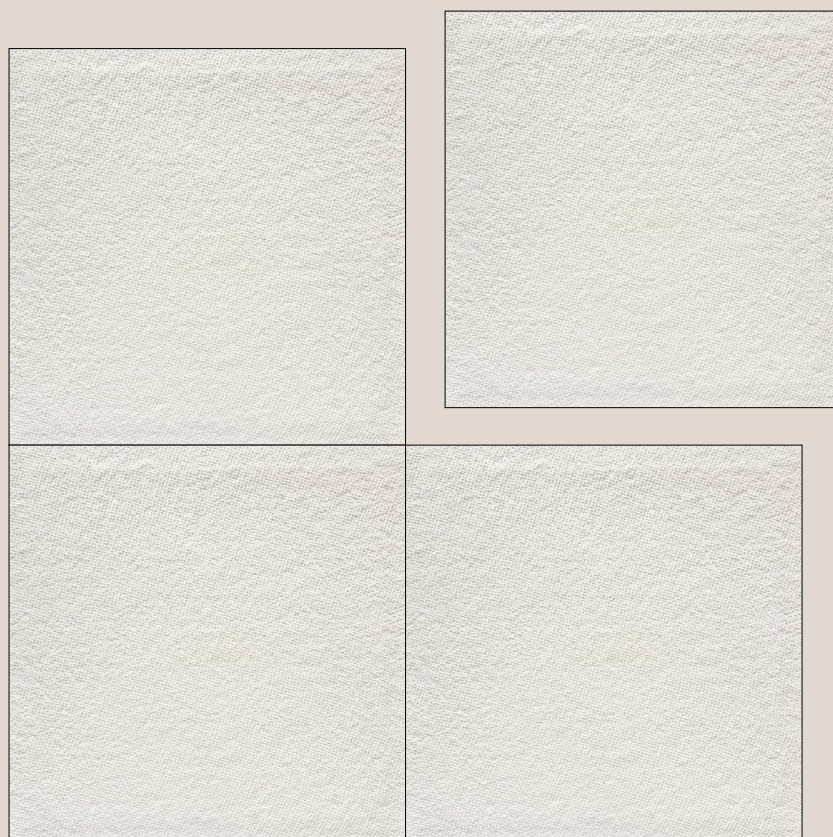

ARCHISONIC® Cotton¹
Tofu *by Cecilie Manz*

938.15.24.249.00
938.15.24.250.00
938.15.24.251.00
938.15.24.252.00
938.15.24.121.00

TECHNICAL DATA SHEET

ARCHISONIC® Cotton Tofu

General Information



Data

Applicable Article numbers

PUTTY WHITE	PAPER GRAY	GREENISH	CLAY	FLAX 10
938.15.24.249.00	938.15.24.250.00	938.15.24.251.00	938.15.24.252.00	938.15.24.121.00

Dimensions¹

Length	300mm (±10%)	11.8" (±10%)
Height	300mm (±10%)	11.8" (±10%)
Thickness	24mm (±10%)	0.9" (±10%)

Material

Wall Covering ARCHISONIC® Cotton (100% circular), in 5 special colours.

This material should be handled with care in order to avoid the tiles being damaged or miscoloured.

Weight²

24mm / 0.95"	6.0 kg/m ²	1.13 lbs/ft ²
--------------	-----------------------	--------------------------

Included

ARCHISONIC® Cotton
Tofu (14 tiles)



Z-Clip Installation Jig
(if ordered with Z-Clips)



Installation
guide



Take back
program



1 - all dimensions are nominal 2 - all weights are nominal

ARCHISONIC® Cotton Tofu

Specification Guide

1 Prepare this information:

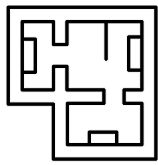

Project Area

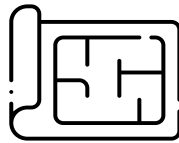

Plans



Other Considerations

2 Specify your Cotton Tile:

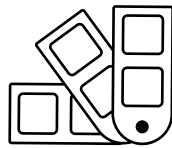

Colour

page 9-11

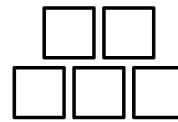

Quantity

(box of 14 tiles)

3 Specify your mounting add-on:

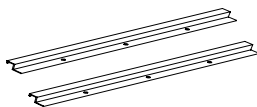

Mounting
Z-Clip profiles

Article Numbers:

938.12.10.000.00: Z-Clip Set for the tiles (28x 260mm Z-Clips, incl. Screws)

938.12.20.000.00: Z-Clip Set for the wall (7x 1200mm Z-Clips, excl. Screws)

NOTE: The amount of Z-clips for the wall may vary depending on the installation:

- For every TOFU tile, you will need 2x 260mm Z-Clips, incl. Screws installed on the tile
- For a full row (4 consequent tiles) you will need 2x 1200mm Z-Clips, excl. Screws installed on the wall.

ARCHISONIC® Cotton Tofu

Geometry Information

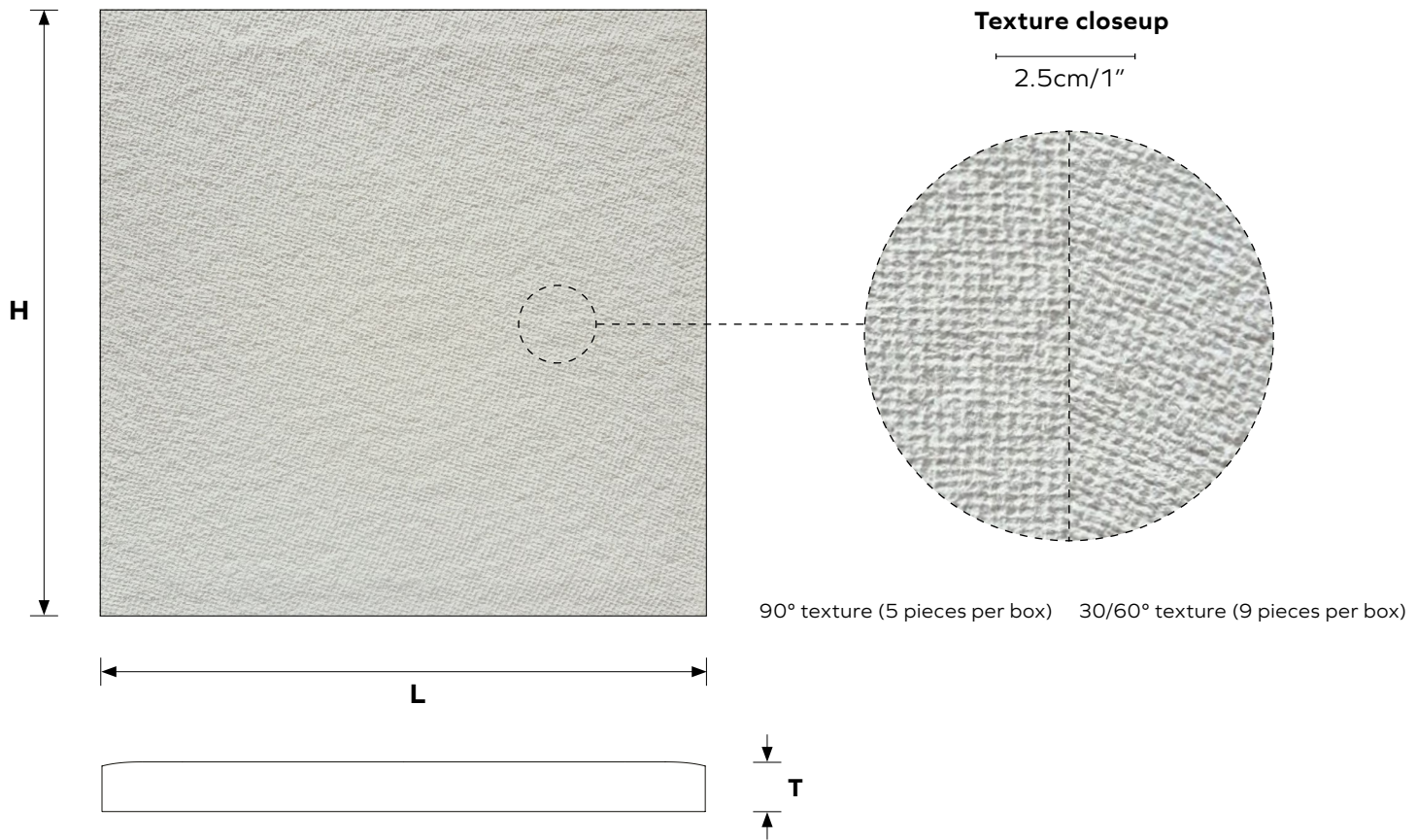

Dimensions table¹

L	Length	300 mm	11.8"
H	Height	300 mm	11.8"
T	Thickness	24 mm	0.9"

1 - all dimensions are nominal

ARCHISONIC® Cotton Tofu

Special Colour Collection *by Cecilie Manz*

Carefully crafted natural tones

ARCHISONIC® Cotton Tofu tiles are available in 5 special colours, carefully crafted by Cecilie Manz, to best complement a unique character ARCHISONIC® Cotton material. Each natural tone was methodically selected to provide best visual appearance on a specially designed haptic tile surface texture.



Colour Name: **Putty White**

Colour code : **249**

NCS: **S 0601-Y**



Colour Name: **Flax 10**

Colour code : **121**

NCS: **S 0603-Y40R**



Colour Name: **Clay**

Colour code : **252**

NCS: **S 1505-Y40R**



Colour Name: **Paper Gray**

Colour code : **250**

NCS: **S 1502-Y**



Colour Name: **Greenish**

Colour code : **251**

NCS: **S 2005-Y**

ARCHISONIC® Cotton Tofu

Recommended Installation Method

For wall installation we recommend using mineral mortar with no or very low content of chemical additives like **Bioflex from Kerakoll**. It is important that mortar is thixotropic and exhibit low vertical slip properties and long open time, like **Bioflex from Kerakoll** (<https://products.kerakoll.com/en/p/bioflex>).

Familiarize yourself with the application instructions for the tile mortar and prepare it accordingly. A notched trowel with 6 x 6 x 6 mm teeth is recommended for working with the tiles (e.g. LUX Classic 6 x 6 mm trowel).

All substrates must be level, hardened and undamaged, resistant, dry and free from binding agents and rising damp. Cementitious substrates can be moistened before application or coated with primer.

Please see full [Installation Guide](#) for more information.

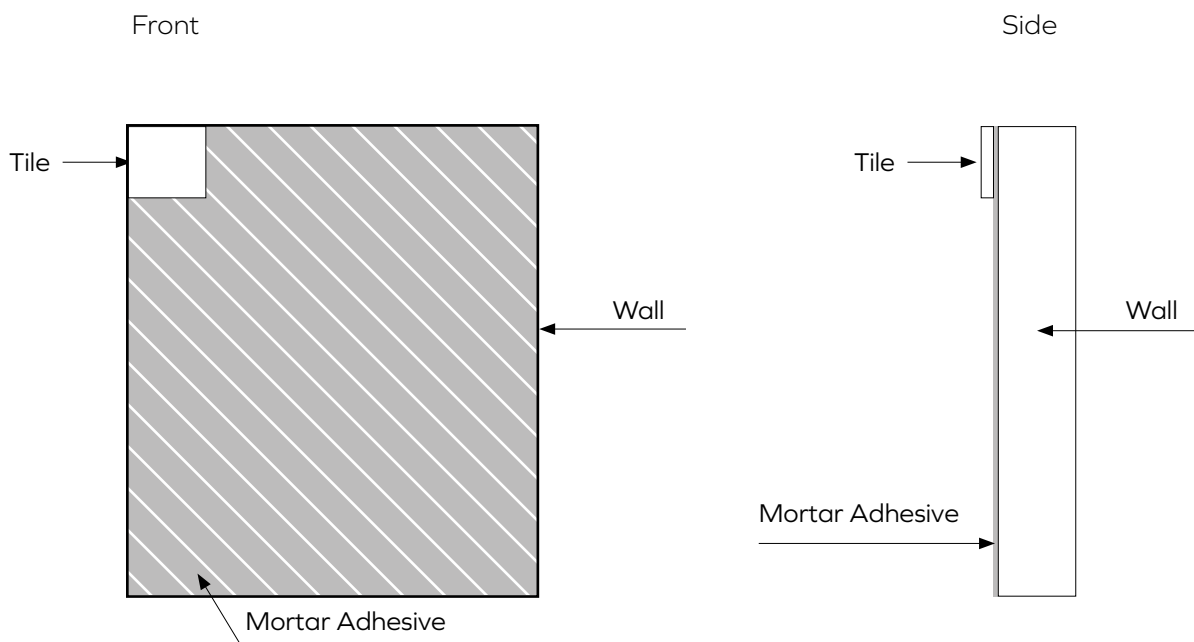
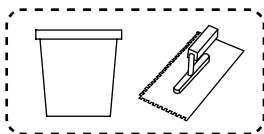

ARCHISONIC® Cotton Tofu

Alternative Installation Method

Z-Clip and the screws are not included in the basic scope of delivery. Installation hardware needs to be ordered separately.

1 Screw the Z-clips to the tiles.

Screw the Z-clips to the tiles using the cardboard jig supplied. For a horizontal position of the tile, fix 2x Z-clips in parallel.

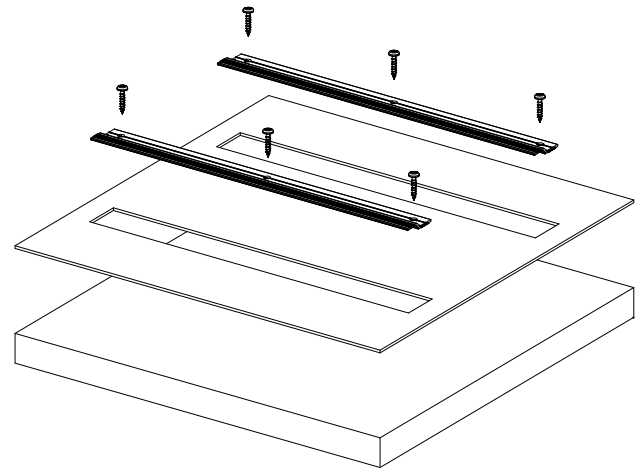

2 Screw Z-clips to the wall

When screwing the Z-clips to the wall, it is recommended to use every third hole in the profile. Please note a distance of 46mm (1.8in) from the bottom z-clip to the start of the covered area is recommended.

If the tiles are to be installed all horizontally or in both vertical and horizontal positions, a greater number of Z-clip sets will be required for the wall. It is always recommended to check over all quantities of Z-clips for the walls with our Consultancy.

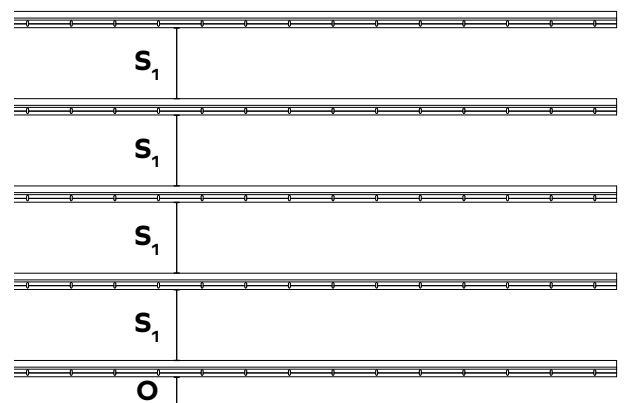

Bottom edge of 1st tile

Spacing for horizontal or mixed layouts

3 Hanging the tiles

Hook the tiles into place.

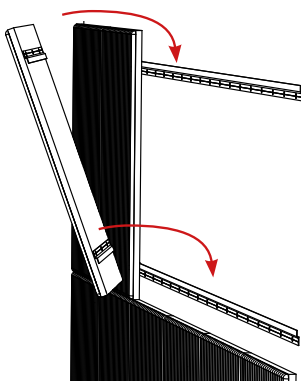

Dimensions table

O	Offset	46 mm	1,8"
S ₁	Spacing 1	122 mm	4,8"

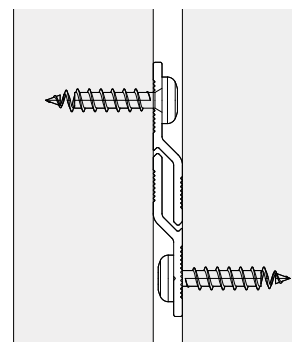

ARCHISONIC® Cotton

Material Specification

Density

250kg/m³
15.6lbs/ft³ (+/-10%)

Tile Thickness

24mm
0.94" (±10%)

Composition

73% cotton cellulose, 26% mineral components
(micronized kaolin, colouring earths, fireproof salts),
<1% acrylic resin

Fire Rating

B-s1, d0 **Class 1**
EN ISO 13823:2010
(tested with Pattex adhesive)
Class A
ASTM E84

VOC Emission

A+
UNI EN ISO 16000-9: 2006 + ISO 16000-6:
2011

Care Instructions

Gently clean with a vacuum cleaner or a dry cloth.
Do not use water, soap or liquid detergents.



EN 15102: 2007 + A1: 2011
0497

ARCHISONIC® Cotton Tofu

Acoustic Performance

Testing Standards

ISO 354:2003	Acoustics — Measurement of sound absorption in a reverberation room
ISO 11654:1997	Acoustics — Sound absorbers for use in buildings — Rating of sound absorption
ISO 20189:2018	Acoustics — Screens, furniture and single objects intended for interior use — Rating of sound absorption and sound reduction of elements based on laboratory measurements
ASTM C423-17	Standard Test Method for Sound Absorption and Sound Absorption Coefficients by the Reverberation Room Method
ASTM E795-16	Standard Practices for Mounting Test Specimens During Sound Absorption Tests

Acoustic Test Result	α_w	SAA	NRC
ARCHISONIC® Cotton 24mm	0.60 (H)	0.56	0.55
ARCHISONIC® Cotton 24mm with 50mm insulation	0.70 (H)	0.66	0.65

The NRC rating is calculated as the average of the absorption coefficients measured at frequencies of 250Hz, 500Hz, 1000Hz and 2000Hz and round to the nearest 0.05. SAA rating is calculated as the average of the sound absorption coefficients of a material for the twelve one-third octave bands from 200Hz through 2500Hz and rounded off to the nearest 0.01.

Acoustic Performance

Frequency (Hz)		125	250	500	1000	2000	4000
ARCHISONIC® Cotton 24mm	α_p	0.15	0.45	0.55	0.55	0.65	0.75
ARCHISONIC® Cotton 24mm with 50mm insulation	α_p	0.55	0.50	0.65	0.70	0.75	0.85

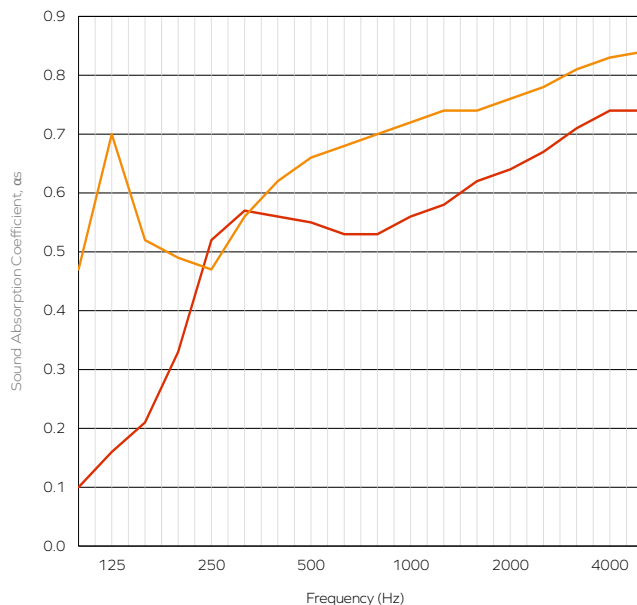

- ARCHISONIC® Cotton 24mm
- ARCHISONIC® Cotton 24mm with 50mm insulation

The table represents the practical sound absorption coefficient (α_p) in accordance with ISO 11654. The graph represents the sound absorption coefficients (α_s) in the third octave band center frequencies in accordance with ISO 354. Measurement used Pink Noise as excitation signal in a reverberant room.

ARCHISONIC® Cotton Tofu

Additional Information

Online Resources

A variety of resources are available online for all of our products. Please visit the product's page for more information.



CAD files



Spec sheets and
Installation Guide



Colour families



Instruction
videos



Associated
products specs.

Ordering Process

Our experienced team of Project Consultants will guide and support you throughout the order process. We fulfill the majority of our orders in as little as 21 days¹ from your first point of contact, allowing you to focus on what truly matters to you.



Contact our
consultant

Quote¹

48h



Order Confirmation

Production¹

2-3 weeks



Dispatch

Transit

location based



Delivery

Contact Us

Ready to make an impact? We are just an email or call away to discuss your project and answer any question.



+41 41 244 14 00



connect@impactacoustic.com



Online form

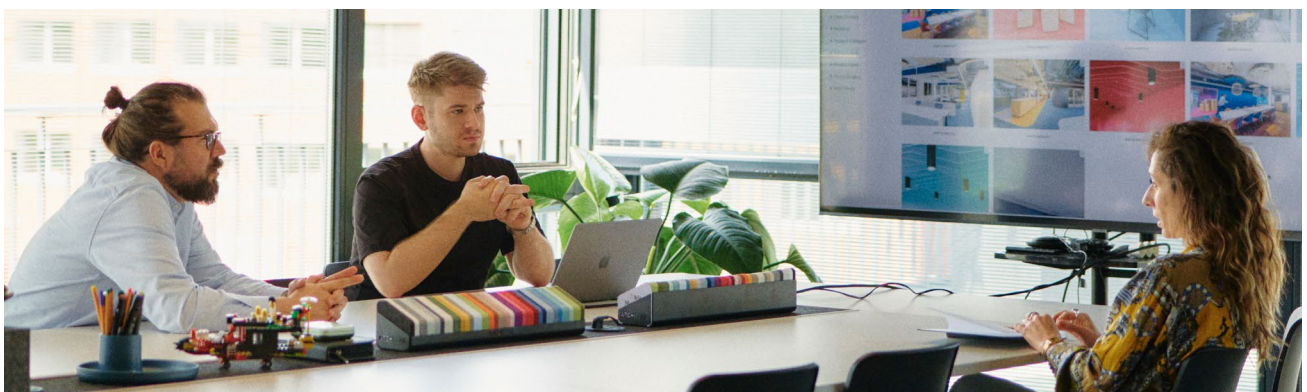

¹ - Quote and Production times may vary.

**#We
Make An
Impact**

connect@impactacoustic.com | www.impactacoustic.com